

NOTE:

- PROVIDE LOW CONSUMPTION WATER CLOSETS AND SHOWERHEADS FOR ALL NEW CONSTRUCTION. EXISTING SHOWER HEADS AND TOILETS MUST BE ADAPTED FOR LOW WATER CONSUMPTION.
- SMOKE DETECTORS SHALL BE PROVIDED FOR ALL DWELLING UNITS INTENDED FOR HUMAN OCCUPANCY. UPON THE OWNER'S APPLICATION FOR A PERMIT FOR ALTERATIONS, REPAIRS, OR ADDITIONS, EXCEEDING ONE THOUSAND DOLLARS. (\$1,000) (R314.6.2)
AN APPROVED SMOKE ALARM SHALL BE INSTALLED IN EACH SLEEPING ROOM & HALLWAY OR AREA GIVING ACCESS TO A SLEEPING ROOM, AND ON EACH STORY AND BASEMENT FOR DWELLINGS WITH MORE THAN ONE STORY. SMOKE ALARMS SHALL BE INTERCONNECTED SO THAT ACTIVATION OF ONE ALARM WILL ACTIVATE ALL THE ALARMS WITHIN THE INDIVIDUAL DWELLING UNIT. IN NEW CONSTRUCTION SMOKE ALARMS SHALL RECEIVE THEIR PRIMARY POWER SOURCE FROM THE BUILDING WIRING AND SHALL BE EQUIPPED WITH A BATTERY BACK UP AND LOW BATTERY SIGNAL.
AN APPROVED CARBON MONOXIDE ALARM SHALL BE INSTALLED IN DWELLING UNITS AND IN SLEEPING UNITS WITHIN WHICH FUEL BURNING APPLIANCES ARE INSTALLED AND IN DWELLING UNITS THAT HAVE ATTACHED GARAGES. CARBON MONOXIDE ALARM SHALL BE PROVIDED OUTSIDE OF EACH SEPARATE DWELLING UNIT SLEEPING AREA IN THE IMMEDIATE VICINITY OF THE BED ROOM AND ON EVERY LEVEL OF A DWELLING UNIT INCLUDING BASEMENTS. (R315)
- ALL BRANCH CIRCUITS THAT SUPPLY 125-VOLT, SINGLE PHASE, 15- AND 20- AMPERE OUTLETS INSTALLED IN DWELLING UNIT BEDROOMS SHALL BE PROTECTED BY AN ARC-FAULT CIRCUIT INTERRUPTER(S). CEC 210.12(b).
- MINIMUM 4" EXHAUST DUCT MUST BE PROVIDED. A FLEXIBLE DUCT CANNOT EXTEND MORE THAN 8 FT. AND CANNOT BE CONCEALED. DRYER EXHAUST CANNOT EXCEED 14 FT. WITH A MAX. OF TWO 90 DEGREE ELBOWS.
- INSULATION SHALL BE INSTALLED ON THE FIRST 5 FEET OF HOT AND COLD WATER PIPES.
- ALL HOT WATER PIPING 3/4" OR LARGER, FROM THE WATER HEATER TO THE KITCHEN FIXTURES SHALL HAVE R-4 INSULATION.
- THE CONSTRUCTION SHALL NOT RESTRICT A FIVE FOOT CLEAR AND UNOBSTRUCTED ACCESS TO ANY WATER OR POWER DISTRIBUTION FACILITIES (POWER POLES, PULL-BOXES, TRANSFORMERS VAULTS, PUMPS, VALVES, METERS, APPURTENANCES, ETC.) OR TO THE LOCATION OF THE HOOK-UP. THE CONSTRUCTION SHALL NOT BE WITHIN TEN FEET OF ANY POWER LINES-WHETHER OR NOT THE LINES ARE LOCATED ON THE PROPERTY. FAILURE TO COMPLY MAY CAUSE CONSTRUCTION DELAYS AND/OR ADDITIONAL EXPENSES.
- PROVIDE 70 INCH HIGH NON-ABSORBENT WALL ADJACENT TO SHOWER AND APPROVED SHATTER-RESISTANT MATERIALS FOR SHOWER ENCLOSURE.
- AN APPROVED SEISMIC SHUTOFF VALVE WILL BE INSTALLED ON THE FUEL GAS LINE ON THE DOWNSTREAM SIDE OF THE UTILITY METER AND BE RIGIDLY CONNECTED TO THE EXTERIOR OF THE BUILDING OR STRUCTURE CONTAINING THE FUEL GAS PIPING. (PER ORDINANCE 170,158) SEPARATE PLUMBING PERMIT IS REQUIRED.
- PLUMBING FIXTURES ARE REQUIRED TO BE CONNECTED TO A SANITARY SEWER OR TO AN APPROVED SEWAGE DISPOSAL SYSTEM. (R308.3)
- KITCHENS SINKS, LAVATORIES, BATHTUBS, SHOWERS BIDETS, LAUNDRY TUBS AND WASHING MACHINE OUTLETS SHALL BE PROVIDED WITH HOT AND COLD WATER AND CONNECTED TO AN APPROVED WATER SUPPLY.
- BATHTUBS AND SHOWER FLOORS, WALLS ABOVE BATHTUBS AND A SHOWERHEAD, AND SHOWER COMPARTMENTS SHALL BE FINISHED WITH A NON-ABSORBENT SURFACE. SUCH WALL SURFACE SHALL EXTEND TO A HEIGHT OF NOT LESS THAN 6 FEET ABOVE THE FLOOR.
- UNIT SKYLIGHTS SHALL BE LABELED BY A LA CITY APPROVED LABELING AGENCY. SUCH LABEL SHALL STATE THE APPROVED LABELING AGENCY NAME, PRODUCT DESIGNATION AND PERFORMANCE GRADE RATING (RESEARCH REPORT NOT REQUIRED). (R308.8.9)
- WATER HEATER MUST BE STRAPPED TO WALL (SEC.607.3, LAPC)
- AUTOMATIC GARAGE DOOR OPENERS, IF PROVIDED SHALL BE LISTED IN ACCORDANCE WITH UL 325.
- WHERE A PERMIT IS REQUIRED FOR ALTERATIONS, REPAIRS OR ADDITIONS EXCEEDING ONE THOUSAND DOLLARS (\$1,000), EXISTING DWELLINGS OR SLEEPING UNITS THAT HAVE ATTACHED GARAGES OR FUEL-BURNING APPLIANCES SHALL BE PROVIDED WITH A CARBON MONOXIDE ALARM IN ACCORDANCE WITH SECTION R315.1. CARBON MONOXIDE ALARMS SHALL ONLY BE REQUIRED IN THE SPECIFIC DWELLING UNIT OR SLEEPING UNIT FOR WHICH THE PERMIT WAS OBTAINED. (R316.2)
- EVERY SPACE INTENDED FOR HUMAN OCCUPANCY SHALL BE PROVIDED WITH NATURAL LIGHT BY MEANS OF EXTERIOR GLAZED OPENINGS IN ACCORDANCE WITH SECTION 44303.1 OR SHALL BE PROVIDED WITH ARTIFICIAL LIGHT THAT IS ADEQUATE TO PROVIDE AN AVERAGE ILLUMINATION OF 8 FOOT-CANDLES OVER THE AREA OF THE ROOM AT A HEIGHT OF 30 INCHES ABOVE FLOOR LEVEL. (R303.1)
- A COPY OF THE EVALUATION REPORT AND/OR CONDITIONS OF LISTING SHALL BE MADE AVAILABLE AT THE JOB SITE.
- THESE PLANS SHALL CONFORM TO ALL NOTES AND REQUIREMENTS LISTED ON PAGE A-1.1 GREEN NOTES.

- POOL NOTES:**
- Provide an alarm for doors to the dwelling that form a part of the pool enclosure. The alarm shall sound continuously for a min. of 30 seconds when the door is opened. It shall automatically reset and be equipped with a manual means to deactivate (for 15 sec. max.) For a single opening. The deactivation switch shall be at least 54" above the floor.
 - Provide anti-entrapment cover meeting the current ASTM or ASME is required for the suction outlets of swimming pool, toddler pool, and spa for single family dwellings per the Assembly Bill (AB) No. 2577.

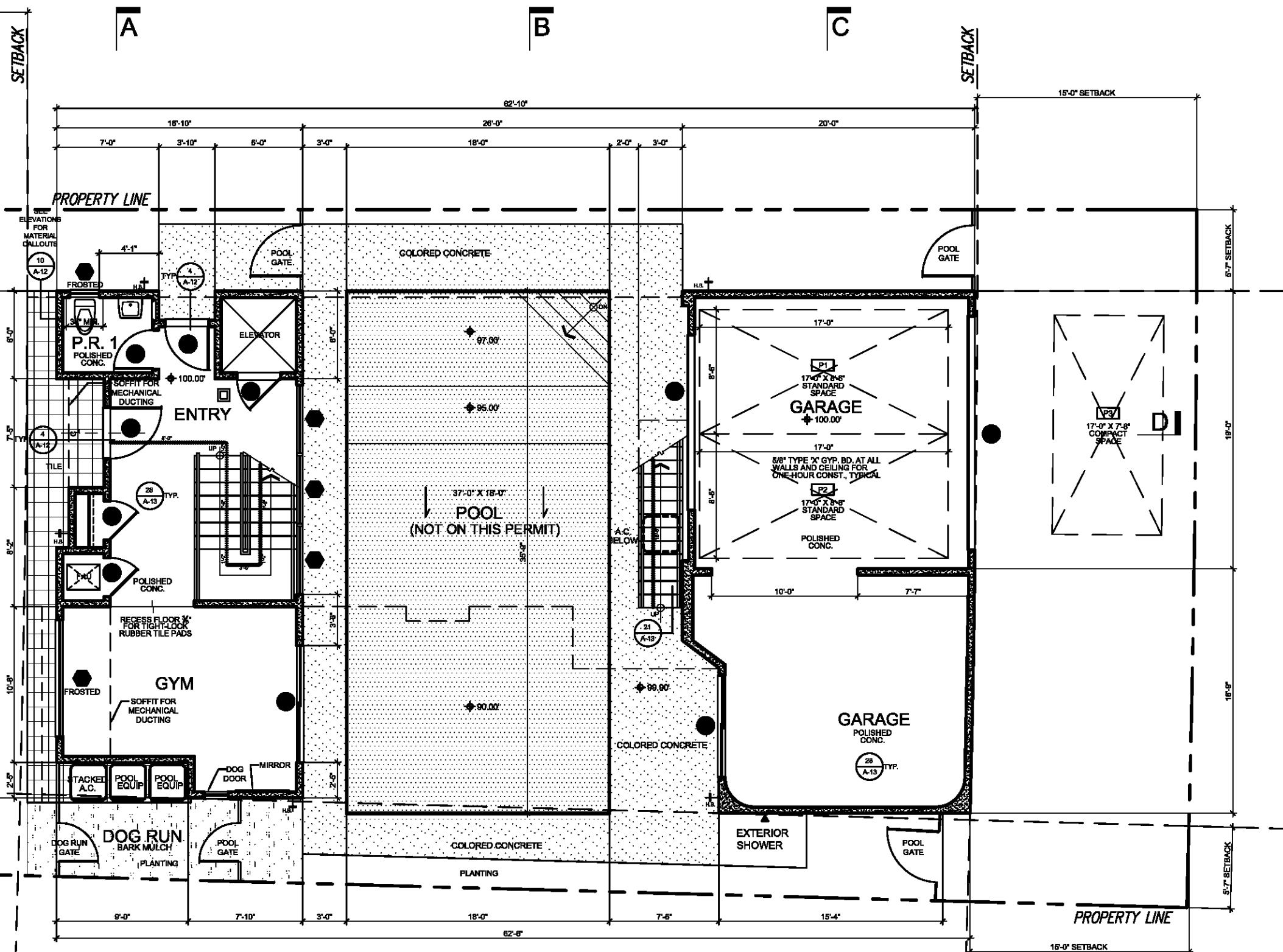

WALL AND SYMBOL KEY:

	EXISTING WALL TO REMAIN
	NEW STUD WALL
	REFINISH EXISTING WALL
	2x6 PLUMBING WALL
	BLOCK OR CONCRETE WALL
	COMMON PATH OF TRAVEL
	TRAVEL DISTANCE TO YARD
	SMOKE DETECTORS

FIRST FLOOR PLAN

FIRST FLR - 933 SQ. FT.
GARAGE - 540 SQ. FT.



KENNETH DAVID LEE
ARCHITECT A.I.A.
13844 VENTURA BLVD. STE. 100
SHERMAN OAKS CA 91423
(818) 990 - 0391
(818) 990 - 3749 FAX

**KLIEN RESIDENCE
FIRST FLOOR PLAN**

DATE: 07.13.12
SCALE: 1/8" = 1'-0"