

REVISIONS	BY
08.01.12	JG
08.02.12	JG
08.09.12	JG

**KENNETH DAVID LEE**  
**ARCHITECT A.I.A.**  
 13844 VENTURA BOULEVARD, SHERMAN OAKS, CA 91423  
 (818) 990 - 0391 FAX (818) 990 - 3749

**KLEIN RESIDENCE**  
**SECOND FLOOR PLAN**  
 DATE: 04.23.12  
 SCALE: 1/4" = 1'-0"  
 SHEET: A-4

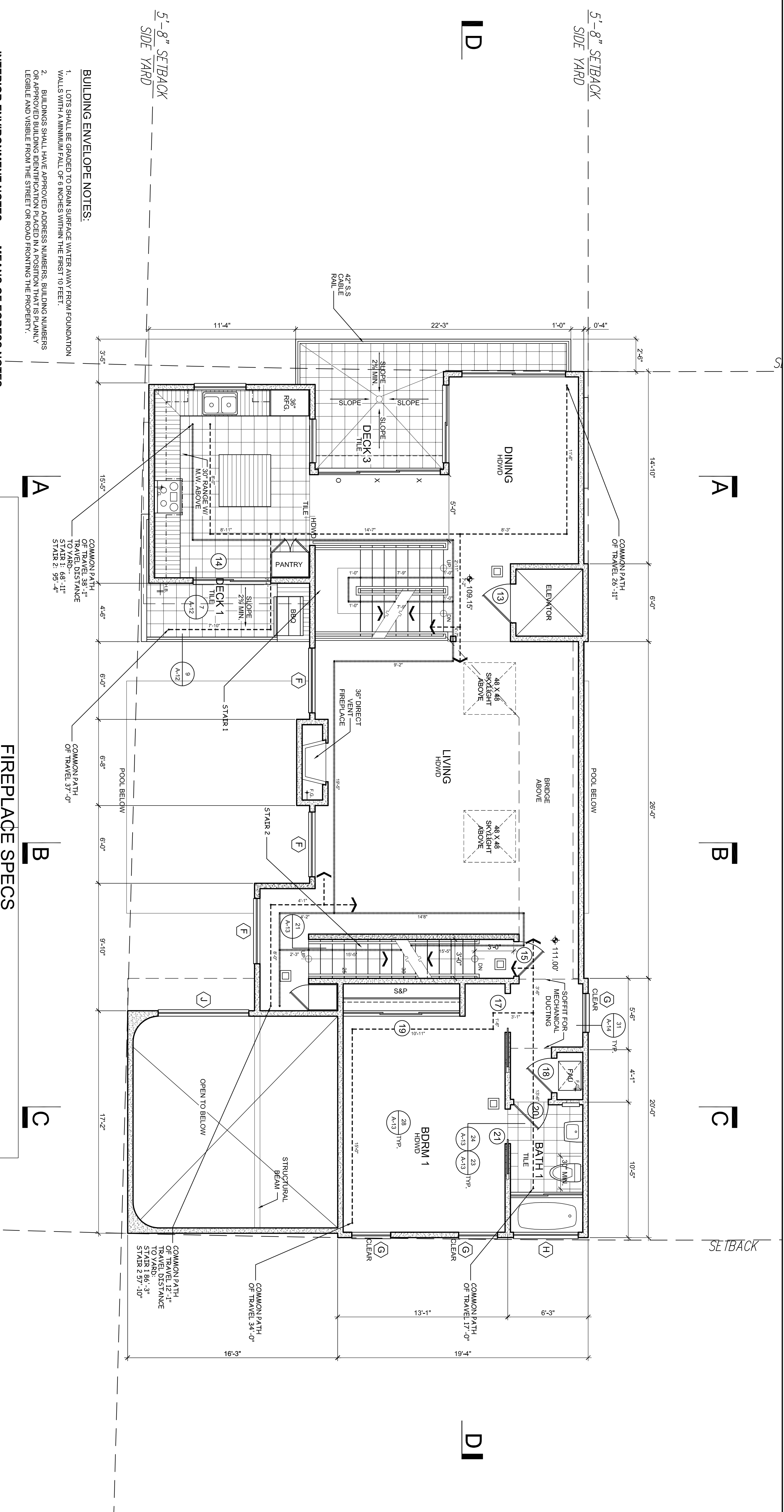

- BUILDING ENVELOPE NOTES:**
1. LOTS SHALL BE GRADED TO DRAIN SURFACE WATER AWAY FROM FOUNDATION WALLS WITH A MINIMUM FALL OF 6 INCHES WITHIN THE FIRST 10 FEET.
  2. BUILDINGS SHALL HAVE APPROVED ADDRESS NUMBERS, BUILDING NUMBERS OR APPROVED BUILDING IDENTIFICATION PLACED IN A POSITION THAT IS PLAINLY LEGIBLE AND VISIBLE FROM THE STREET OR ROAD FRONTING THE PROPERTY.

- INTERIOR ENVIRONMENT NOTES:**
1. PROVIDE NATURAL LIGHT IN HABITABLE ROOMS BY MEANS OF EXTERIOR WALL OPENINGS WITH AN AREA NOT LESS THAN 8% FLOOR AREA. (R303.1)
  2. PROVIDE NATURAL VENTILATION IN HABITABLE ROOMS AND BATHROOMS BY MEANS OF OPERABLE EXTERIOR WALL OPENINGS WITH AN AREA NOT LESS THAN 4% OF FLOOR AREA. MECHANICAL VENTILATING SYSTEMS MAY BE PERMITTED. (R303.1)
  3. BATHROOMS, WATER CLOSET COMPARTMENTS AND OTHelloRETOILETS SHALL BE PROVIDED WITH NATURAL VENTILATION OR WITH MECHANICAL VENTILATION CAPABLE OF 50 CFM EXHAUSTED DIRECTLY TO THE OUTSIDE. (R303.3)
  4. HEATER SHALL BE CAPABLE OF MAINTAINING A POINT 3 FEET ABOVE THE FLOOR AND 2 FEET FROM EXTERIOR WALLS IN ALL HABITABLE ROOMS AT THE DESIGN TEMPERATURE. (R303.8)

- MEANS OF EGRESS NOTES:**
1. FOR HABITABLE LEVELS OR BASEMENTS LOCATED MORE THAN ONE STORY ABOVE OR MORE THAN ONE STORY BELOW AN EGRESS DOOR, THE MAXIMUM TRAVEL DISTANCE FROM ANY OCCUPIED COMMON STAIR OR EGRESS DOOR TO THE HABITABLE ROOMS AND BATHROOMS SHALL NOT EXCEED 50 FEET. (R311.4)
  2. THE REQUIRED NUMBER OF EXITS FROM ANY STORY, BASEMENT OR INDIVIDUAL SPACE SHALL BE MAINTAINED UNTIL ARRIVAL AT GRADE OR THE PUBLIC WAY. (R311.1)
  3. PROVIDE EMERGENCY EGRESS FROM SLEEPING ROOMS. SEE DETAIL 31 ON SHEET A-14.
  4. A LANDING SHALL BE PROVIDED AT THE TOP AND BOTTOM OF STAIRWAYS.
  5. ENCLOSED ACCESSIBLE SPACE UNDER STAIRS SHALL HAVE WALLS, UNDERSTAIR SURFACE AND ANY NICHS PROTECTED ON THE ENCLOSED SIDE WITH 1/2 INCH GYPSUM BOARD. (R302.7)

**FIREPLACE SPECS**  
 EDV-3530, EDV-4035, EDV-4540

MODEL	A	B	C	E	F	G	H
WIDTH	30 1/2"	30 1/2"	30 1/2"	30 1/2"	30 1/2"	30 1/2"	30 1/2"
DEPTH	18 1/2"	18 1/2"	18 1/2"	18 1/2"	18 1/2"	18 1/2"	18 1/2"
HEIGHT	42"	42"	42"	42"	42"	42"	42"
WEIGHT	100 LB	100 LB	100 LB	100 LB	100 LB	100 LB	100 LB

**FRAMING SPECIFICATIONS**  
 EDV-3530, EDV-4035, EDV-4540

TYPE	SPACING
WOOD STUDS	16" O.C.
WOOD JOISTS	16" O.C.
WOOD RAFTERS	16" O.C.
WOOD TRUSSES	16" O.C.
WOOD SHEATHING	1/2" CDX
WOOD FLOORING	3/4" T&G

