

KKE Architects, Inc.
525 e. colorado Blvd. 4th floor
pasadena, ca 91101

(626) 796-6230
(626) 796-6735 FAX
www.kke.com

minneapolis
las vegas
pasadena
ny ny

ARCHITECTS SEAL

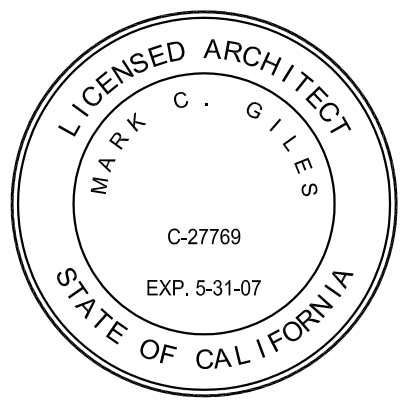

A PROJECT FOR

Longca Drugs
Live healthy. Live happy. Live Longca

LONGCS DRUG STORES
141 North Civic Drive,
Walnut Creek, CA 94596

T: 925.210.6792 F: 925.210.6873

PROJECT LOCATION

Longca VENICE
VENICE RENAISSANCE
255 MAIN STREET
VENICE, CALIFORNIA

No.	Date	Revision Description
01	07/17/2006	1st PLAN CHECK SUBMITTAL
02	10/16/2006	PLAN CHECK RE-SubMITTAL
03	11/14/2006	PLAN CHECK RE-SubMITTAL
04	01/09/2007	ISSUED FOR CONSTRUCTION
		BULLETIN No. 3

FLOOR PLAN

Project: 06/9/125721
Date: July 17 2006
Drawn by: S. BRONSO
Checked by: G. NAYVAL
Drawing Number: **A-2**

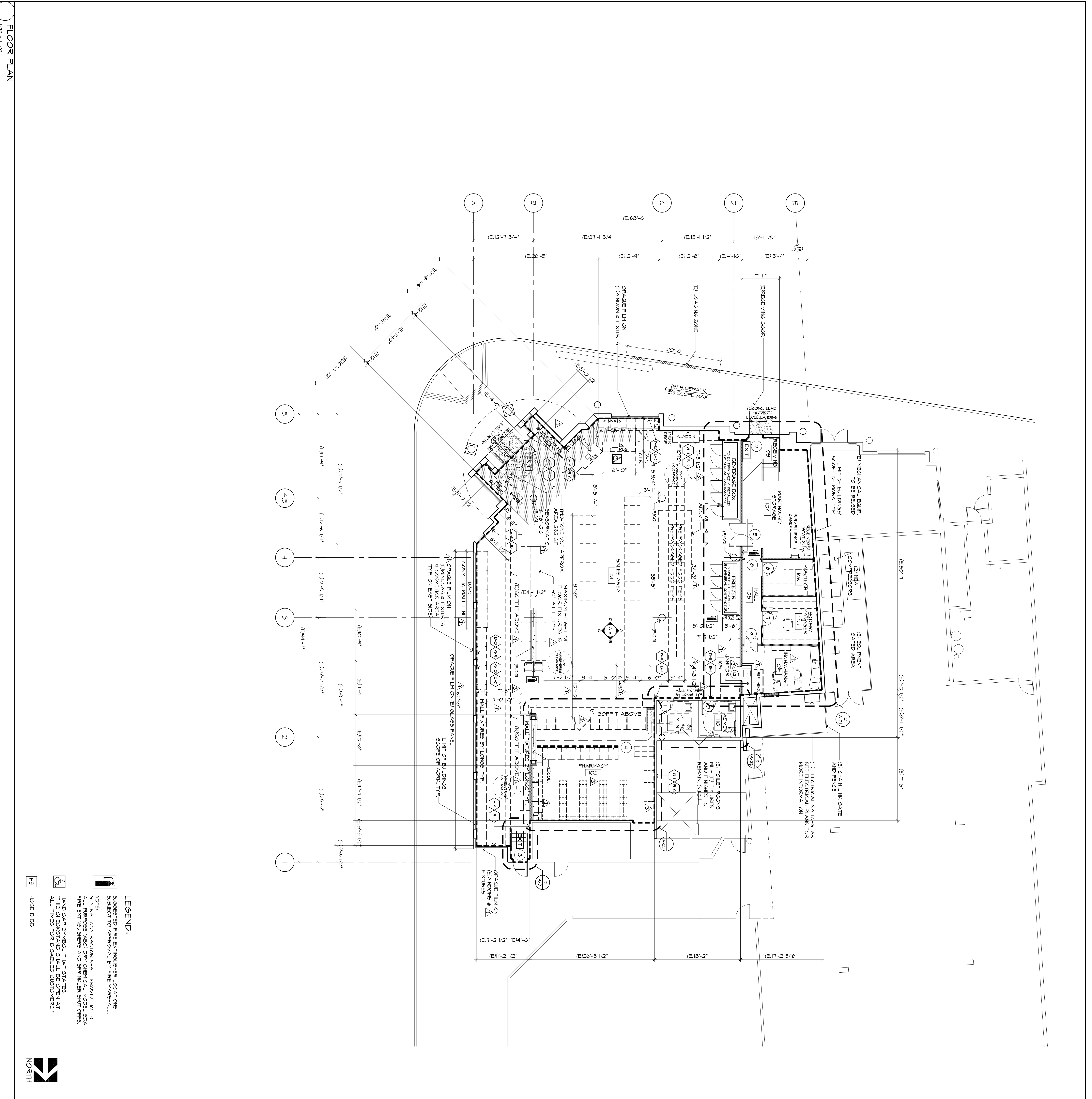

FLOOR PLAN
1/05 - 1-107

MISCELLANEOUS FINISHES

FLOOR

1. VINYL TILE AT SALES AREA SHALL BE:
 11. ANTI-STATIC STANDARD EXCELION INTERLAY TEXTURE
 - NO. 5104 SANDRIFF WHITE - 20%
 - NO. 5166 SANDRIFF WHITE - 20%
 - NO. 5104 EARTHSTONE BEIGE - 60%
12. SALES AREA AT ENTRY DOOR:
 - NO. 5166 SANDRIFF WHITE - 20%
 - NO. 5166 SANDRIFF WHITE - 20%
13. SALES AREA AT PHOTO DEPARTMENT:
 - ANTI-STATIC STANDARD EXCELION INTERLAY TEXTURE
 - NO. 5100 EARTH STONE
14. PHARMACY AND ALL OTHER AREAS WHERE VICTIS IS INDICATED:
 - ANTI-STATIC STANDARD EXCELION INTERLAY TEXTURE
 - NO. 51421 SANDY BEACH

CARPET

3. CARPET INTERFACE FLOORING SYSTEM:
 - MARKERESH NO. 1121 FEL WITH KENSTEP BACKING
4. RUBBER BASE AT PHARMACY:
 - JOHNSONITE GENESIS COLLECTION TGS 82 BLACK PEAK
5. RUBBER BASE AT MANAGERS OFFICE:
 - JOHNSONITE GENESIS COLLECTION TGS 82 BLACK PEAK
6. SAFETY TILE FLOORING IN WAREHOUSE:
 - ANTISTATIC SAFETY TILE 18" X 18" X 1/4"
 - ANTISTATIC FLOORING BY SOMMERSON SOLUTIONS PRODUCTS, COLOR: CLEAR

COLUMN

1. MAKEUP THE FLOOR (4) EXPOSED STEEL COLUMNS IN THE SALES AREA WITH STAINLESS STEEL UP TO 5'-0" IN HEIGHT. PAINT EXPOSED STEEL COLUMN FROM 5'-0" HIGH UP TO CEILING HEIGHT OR TO THE COLOR. PAINT COLOR TO MATCH BENUJANI WOODS #1232-TO SWISS WHITE

MALL MATERIAL

- (M-1) (E) CONCRETE MALL, NO FINISH ON THE INTERIOR
- (M-2) SEE SHEET A-1 FOR FINISH
- (M-3) SEE SHEET A-1 FOR FINISH
- (M-4) 6" X 18 GA. # 16 G.C. TO THE UNDERSIDE OF THE ROOF WITH REFER TO PARTITION TYPE 2B PER DETAIL 3A-B.
- (M-5) SPECIAL CONDITION A, 1, INSTALL OSB TO THE ROOF STRUCTURE ON THE WAREHOUSE SIDE.
- (M-6) SPECIAL CONDITION B, 1, SPECIAL CONDITION B, 1, INSTALL OSB TO THE ROOF STRUCTURE ON THE WAREHOUSE SIDE.
- (M-7) 4" X 18 GA. # 16 G.C. TO THE UNDERSIDE OF THE ROOF WITH REFER TO PARTITION TYPE 2B PER DETAIL 3A-B.
- (M-8) 4" X 18 GA. # 16 G.C. TO THE UNDERSIDE OF THE ROOF WITH REFER TO PARTITION TYPE 2B PER DETAIL 3A-B.
- (M-9) 4" X 18 GA. # 16 G.C. TO THE UNDERSIDE OF THE ROOF WITH REFER TO PARTITION TYPE 2B PER DETAIL 3A-B.
- (M-10) SPECIAL CONDITION A, 1, INSTALL OSB TO THE ROOF STRUCTURE ON THE WAREHOUSE SIDE.
- (M-11) SPECIAL CONDITION B, 1, SPECIAL CONDITION B, 1, INSTALL OSB TO THE ROOF STRUCTURE ON THE WAREHOUSE SIDE.
- (M-12) 2" X 12" X 18 GA. # 16 G.C. TO THE UNDERSIDE OF THE ROOF COVERED WITH GYPSUM WALLBOARD ON BOTH SIDES TO 4" ABOVE CEILING. REFER TO PARTITION TYPE 2B SIMILAR PER DETAIL 3A-B.
- (M-13) 4" X 18 GA. # 16 G.C. FROM 1'-0" ABOVE FINISH FLOOR TO 1'-2" ABOVE CEILING WITH GYPSUM WALLBOARD ON INTERIOR SIDE TO NOTE STUDS INSTALLED ON TOP OF EXISTING 2" HIGH STEEL MALL. REFER TO PARTITION TYPE 2E PER DETAIL 3A-B.
- (M-14) 4" X 18 GA. # 16 G.C. FROM 1'-0" ABOVE FINISH FLOOR TO 1'-2" ABOVE CEILING WITH GYPSUM WALLBOARD ON INTERIOR SIDE TO NOTE STUDS INSTALLED ON TOP OF (E) INTERIOR MALL WITH (E) GYPSUM BOARD ON BOTH SIDES TO 4" ABOVE FINISH FLOOR. REFER TO PARTITION TYPE 2E PER DETAIL 3A-B.
- (M-15) (E) EXTERIOR METAL STUD WALL WITH (E) GYPSUM BOARD SOFFIT # ADJACENT WINDON.
- (M-16) (E) EXTERIOR METAL STUD WALL, ADD NEW GYPSUM BOARD SOFFIT AT ADJACENT WINDON.
- (M-17) (E) 4" OR 6" X 18 GA. # 16 G.C. TO 1'-2" ABOVE CEILING WITH (E) WATER RESISTANT GYPSUM BOARD ON TOILET ROOM SIDE TO 4" INSULATION WITH FULL HEIGHT HEAD MALL COVERING ON THE TOILET ROOM SIDE.
- (M-18) (E) EXTERIOR METAL STUD WALL WITH (E) GYPSUM BOARD ON INTERIOR TO (E) SOFFIT, TO REMAIN.

BASE MATERIALS

- (B-0) NO BASE BEHIND WALL FIXTURES
- (B-1) 4-INCH HIGH STANDARD TORSETT CORE BASE, MATTE FINISH TGS 82 BLACK PEAK
- (B-2) 6-INCH HIGH STANDARD TORSETT CORE BASE, MATTE FINISH TGS 82 BLACK PEAK
- (B-3) 4-INCH HIGH STANDARD CARPET BASE, MATTE FINISH BLACK PEAK
- (B-4) 4-INCH ALTRIO SAFETY FLOORING COVERED BASE BLACK PEAK
- (B-5) 3 1/2-INCH (FROM 1" X 4") WOOD BASE WITH SEAL COAT.

NOTES:

1. REFER TO DETAILS 3A-B FOR WALL PARTITION BRACING DETAILS.
2. REFER TO DETAIL 3A-B FOR SUGGESTED LAYOUT OF VINYL TILE IN THE SALES AREA.
3. REFER TO NOTES ON SHEET A-1 FOR APPLICABLE NOTES OF VINYL TILE INSTALLATION.
4. SPRINGWATER ANT-HEFT SYSTEM SHALL BE FINISHED BY LONGCS AND INSTALLED BY GENERAL CONTRACTOR.

ATTN: GENERAL CONTRACTOR
INSTALL ISOLATOR PADS AND SPRINGS AT ALL CORNERS OF EACH COMPRESSION UNIT.

LEGEND:

- SUGGESTED FIRE EXTINGUISHER LOCATIONS SUBJECT TO APPROVAL BY THE MARSHALL.
- GENERAL CONTRACTOR SHALL PROVIDE TO BE INSTALLED (AND/OR FOR CHECK/VERIFY) ALL FIRE EXTINGUISHERS AND SPRINKLER SHUT-OFFS.
- HANDICAP SYMBOL THAT STATES ALL LINES FOR DISABLED CUSTOMERS.
- HOSE BIBS

