



APPLICATION SUMMARY SHEET

RECEIVED

PAGE 1

PROJECT NAME The Pacific Leadership Garden		MAR 9 2010
BRIEF PROJECT DESCRIPTION (50 WORDS OR LESS) We plan to teach our students leadership and the value of service by guiding them through the redesign of The Pacific Leadership Garden. Alongside faculty, parents, local businesses and conservationists, through this project our students will deepen their connection to the Venice community and build bridges back to their own.		
PROJECT SITE NAME AND FULL ADDRESS Westside Leadership Magnet 104 Anchorage Street, Marina Del Rey, CA 90292		
PROJECT COMPLETION DATE August 25, 2010	# OF VENICE STAKEHOLDERS TO BENEFIT BY THIS PROJECT Numerous	

ORGANIZATION OR STAKEHOLDER NAME Westside Boost		
QUALIFYING ADDRESS 104 Anchorage Street, Marina Del Rey, CA 90292		
DAY PHONE 310-823-7344	EVENING PHONE 310-823-7344	CELL PHONE 310-482-0422
E-MAIL ADDRESS Laura@WestsideBoost.com		FAX

PROJECT MANAGER Laura Alice	TITLE President	
MAILING ADDRESS 310 Venice Way, Suite B, Venice, CA 90291		
DAY PHONE 310-823-7344	EVENING PHONE 310-823-7344	CELL PHONE 310-482-0422
E-MAIL ADDRESS Laura@WestsideBoost.com		FAX

BY SIGNING BELOW, I agree to the terms of the 2010-11 Community Improvement Project funding guidelines. I also acknowledge that the information submitted in this application is accurate to the best of my knowledge. Submitting an application with misleading information may be cause for d

AMOUNT REQUESTED \$2,000

REVIEW (For Office Use Only)

PROJECT # (For Office Use Only) 7

STAKEHOLDER SIGNATURE

Laura Alice

PROJECT MANAGER SIGNATURE

2/15/2010

DATE

2/25/2010

DATE



PROJECT DESCRIPTION SHEET

PROJECT DESCRIPTION (Include how many stakeholders will be working on this project.) (Maximum 500 words)

"The most dangerous leadership myth is that leaders are born – that there is a genetic factor to leadership. This myth asserts that people simply either have certain charismatic qualities or not. That's nonsense; in fact, the opposite is true. Leaders are made rather than born." - Warren G. Bennis

At Westside Leadership Magnet School, we want our students to grow into good leaders. For our neighborhood, for our satellite communities that many of our students travel from each day, and for our city as a whole. Leadership is a key focus for our school, and we want to give our students an opportunity to experience environmental leadership firsthand through the planning, development, and creation of the Pacific Leadership Garden. In taking the steps to beautify our school for the benefit of our close neighbors, the community at large and the many tourists to Venice who visit the Grand Canal and the local beach, we can achieve this goal.

We are a self-contained magnet school, meaning that an overwhelming majority of our students are bused in from all over Los Angeles. Some travel more than an hour to get to school. All the children who attend Westside must apply for admission. We are not a community school. It is a strange concept for a school to not belong to a community. As parents and a community support group for Westside Leadership Magnet, we are working hard to overcome this and to involve the local community in our school. Approximately 20% of our students are English learners and more than 85% come from homes at or below the poverty line. These statistics are in stark contrast to the affluent neighborhood in which the school resides. By creating projects that engage the community and working to build partnerships with surrounding businesses and residents, the local community benefits, the students of Westside Leadership benefit and their home communities benefit as well. Knowledge is power and these kids take this power home every single day. The VNC Community Improvement Project Grant is the perfect program for helping unite the pieces of this variegated community.

Our goal is to use this grant to start a process of reinvigorating the community's involvement in our school, to literally bring together neighbors who share a wall but don't know each another. We want our students to understand that school doesn't happen just in the classroom, and that a school is bigger than the boundary of its walls. We want our students to learn from experience that with leadership and effort, you can create community wherever you are.

IS THIS PROJECT PART OF A LARGER PROJECT? YES NO

COMMUNITY BENEFIT (Description of benefit to the entire community and justification for these benefits)

We believe that the creation of the Pacific Leadership Garden will help to beautify the neighborhood and encourage appreciation of the native California plant and wildlife. The Pacific Leadership Garden is located in an extremely visible location in our community. In addition to the locals who pass it on their way to get their morning coffee, numerous tourists walk by after a day at the beach, a visit to the local restaurants, or a tour through the Venice Canals. We plan to revitalize this ignored area and highlight the beauty that can be found all around the neighborhood. We believe that the creation of



**SUPERIOR
TREE CARE**
State License 765846

Date: February 26, 2010
 Customer Name: Michael Flaherty
 Address: 104 Anchorage St Marina Del Rey
 Phone Number: 310-277-7555

Proposal / **Contract**

We hereby submit specifications and estimates for:

- Tree(s) trim located in back / front / side
 - Tree(s) shape located in back / front / side
 - Tree(s) prune located in back / front / side
 - Tree(s) remove without stump located in back / front / side
 - 4 Malibu Tree(s) removal with stump located in back / front / side
 - Palm tree(s) trim and/or skin located in back / front / side
 - Palm tree(s) remove with or without stump
 - Tree(s) crown reduction located in back / front / side
 - Tree(s) dead wooding located in back / front / side
 - Tree(s) side trim only
 - Complete clean up and removal of debris and materials on all projects ✓
- Bush(es) trim back / front / side
 - All Bush(es) remove back / front / side
 - Hedge trim located back / front / side
 - Lot or hillside clean up
 - Stump removal located back / front / side
 - Ivy topping located back / front / side
 - Other: _____
 - Keep tree logs

Be advised that trimming trees in excess of 15% may have negative health effects.
 Trees may be diseased or infested. Superior Tree Care can not be responsible for added stress due to trimming.
 *Suggest you contact specialist for treatment.

We advise hereby to furnish service to complete in accordance with above specifications for the sum of: \$1800.00

First payment \$ _____ Check# _____ Final payment due upon completion \$ _____

All service is guaranteed to be as specified. All work to be completed in a workmanlike manner according to standard practices. Any alteration or deviation from above specifications involving extra cost will be executed only upon written orders, and will become an extra charge over and above the estimate. All agreements contingent upon strikes, accidents, weather or delays beyond our control. Owner to carry fire, tornado, and other necessary insurance. Our workers are fully covered by Workman's compensation insurance. If either party becomes involved in litigation arising out of the contract or the performance thereof, the court shall award to the prevailing party its reasonable costs and expenses including attorney's fees.

Authorized Contractor [Signature]

Acceptance of Proposal

The above prices, specifications and conditions are satisfactory and are hereby accepted. You are authorized to do the work as specified. Payment will be made as outlined. "You, the buyer, may cancel this transaction at anytime prior to midnight of the third business day after the date of this transaction. Behind this page is the notice of cancellation form for an explanation of this right". Superior Tree Care and employees are not responsible for any property damage including but not limited to sprinklers, pipes, electrical, etc. arising from any negligent act or omission by Superior Tree Care and its employees in the process of removing stumps or roots unless prearranged in writing.

Date of Acceptance: _____ Signature: _____

Print Name: _____

Approximate date of completion: _____

data work will begin

Las Pilitas Nursery

Plant Name	Size	Quantity	Unit Price	Total Price
Umbellularia Californica	Five Gallon	5	\$29.99	\$149.95
Abronia Umbellata	One Gallon	42	\$7.00	\$294.00
Baccharis Pilularis	One Gallon	9	\$7.99	\$71.91
Camissonia Cheiranthifolia	One Gallon	44	\$7.99	\$351.56
Elymus Condensatus	One Gallon	8	\$7.99	\$63.92
Gnaphalium Californicum	One Gallon	22	\$7.99	\$175.78
Isomeris Arborea	One Gallon	6	\$9.99	\$59.94
Lotus Scoparius	One Gallon	42	\$7.99	\$335.58
Salvia Dara's Choice	One Gallon	12	\$7.99	\$95.88

	\$1,598.52
Tax (8.75%)	<u>\$139.87</u>
Total	\$1,738.39

Las Pilitas Nursery

8331 Nelson Way, Escondido, CA 92026



PROJECT PLANNING SHEET

PAGE 4

WORK PLAN (Include a TIME-LINE for the project with beginning date and completion date of each phase)

Work on the Pacific Leadership Garden project will begin in July and be completed no later than August 25th, 2010.

(Duration is approximately 6 weeks)

1. Removal of existing trees, plants & railing system.
2. Repair of existing irrigation system.
3. Resurfacing and sculpting the garden landscape.
4. Plant installation.

MAINTENANCE PLAN (If applicable)

- There is an irrigation system already in place at this site.
- LAUSD currently maintains the landscaping.
- Westside Boost & Westside Leadership Magnet will provide education & training to LAUSD plant managers on proper care and upkeep of the new plants.
- Thomas Bangert, a teacher and Magnet Coordinator at Westside Leadership Magnet, is also a Master Gardener who will help supervise the plant maintenance to be sure the

plants are receiving proper care.

PROJECT RENDERING SHEET (If applicable)

Attach conceptual images of the project to this sheet or design and print your own sheet. Include text explanations.

Existing Garden on Pacific Avenue

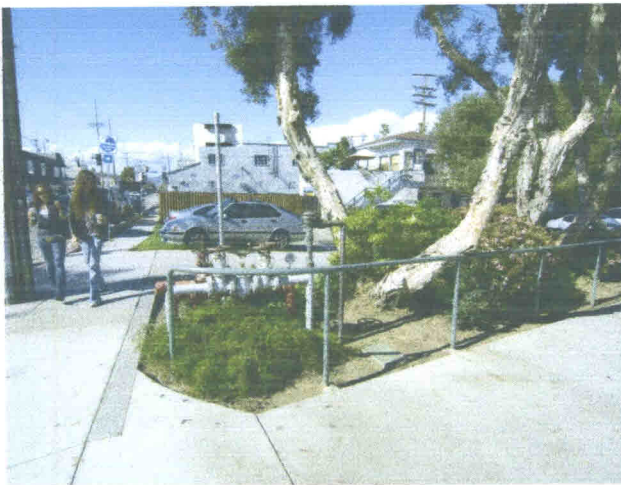



The photos above show the existing trees lining the entrance of the school. As you can see, these trees have been seriously damaged and they are damaging the existing railing system. We plan to remove the railing system and to replace these trees with the California Bay Laurel (*Umbellularia Californica*).



Sprinkler System



Existing sprinkler system is functional, but as you can see in the photos below it is in need of serious repair.

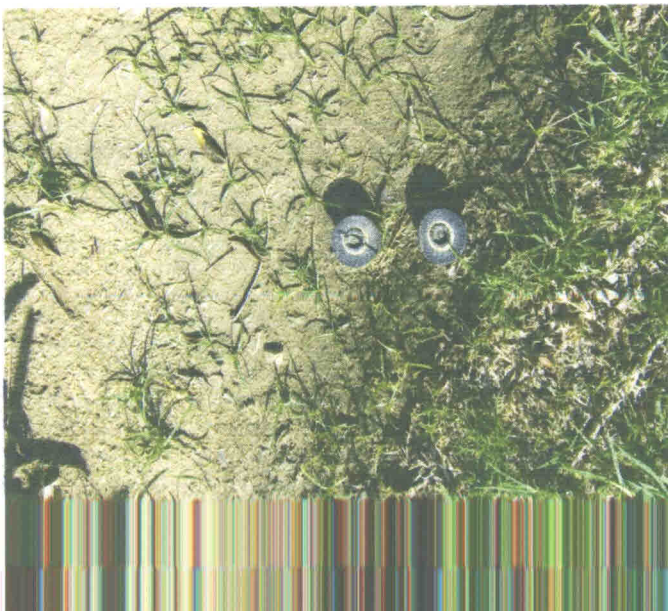

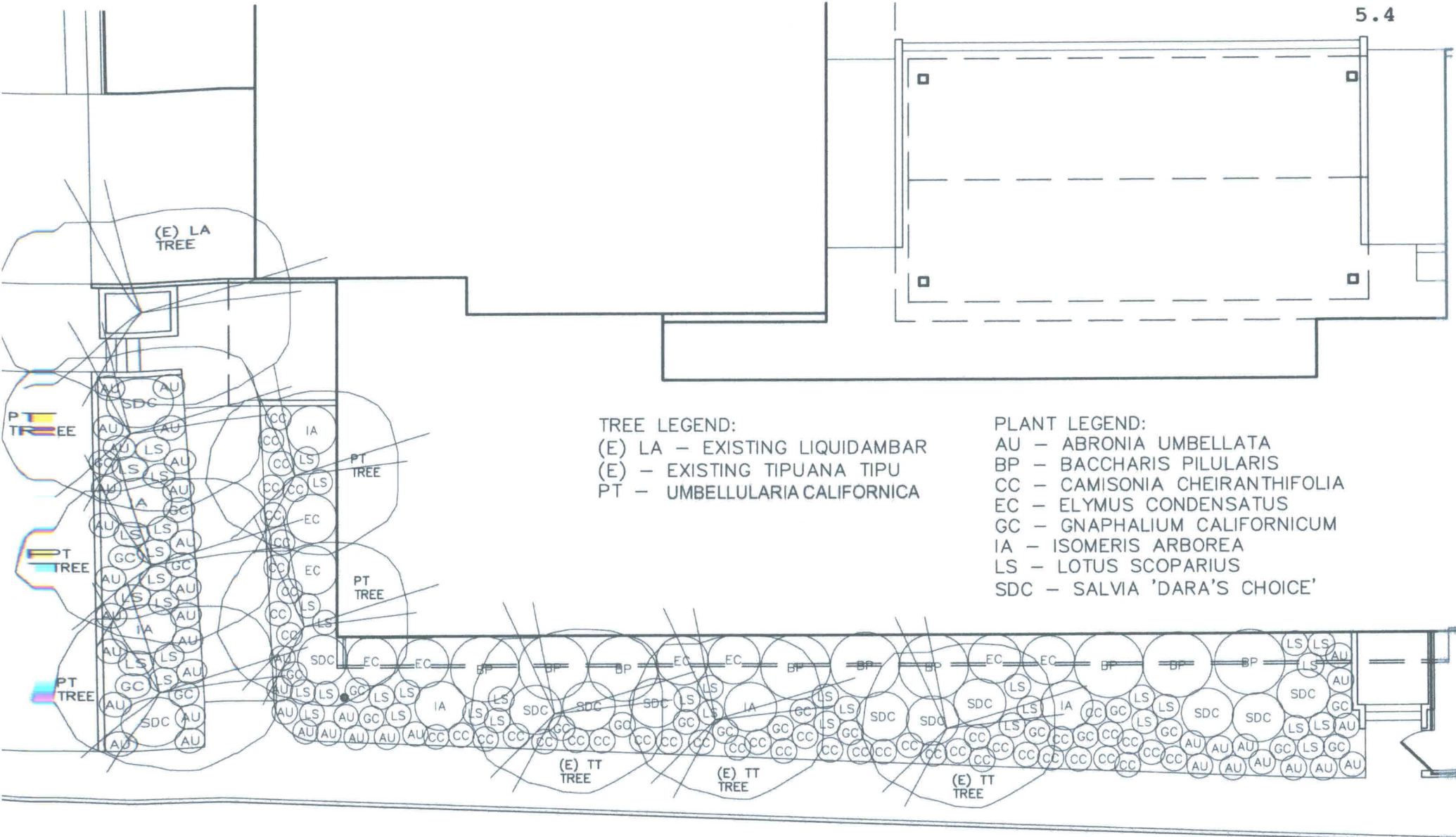

TREE LEGEND:
 (E) LA - EXISTING LIQUIDAMBAR
 (E) - EXISTING TIPUANA TIPU
 PT - UMBELLULARIA CALIFORNICA

PLANT LEGEND:
 AU - ABRONIA UMBELLATA
 BP - BACCHARIS PILULARIS
 CC - CAMISONIA CHEIRANTHIFOLIA
 EC - ELYMUS CONDENSATUS
 GC - GNAPHALIUM CALIFORNICUM
 IA - ISOMERIS ARBOREA
 LS - LOTUS SCOPARIUS
 SDC - SALVIA 'DARA'S CHOICE'





ORGANIZATION SHEET (If applicable)

(Only complete this form if the applicant is an organization. If so, do not complete Page 7)

ORGANIZATION NAME	Westside Boost
ORGANIZATION ADDRESS	104 Anchorage Street, Marina Del Rey, CA 90292
ORGANIZATION DESCRIPTION AND PURPOSE (Include the experience that your organization has in the execution of similar projects)	<p>Westside Boost is a dedicated group of parents, educators, community leaders and local business people committed to achieving academic excellence for every student at Westside Leadership Magnet School. We support various projects at the school and throughout the community. We have worked with Heal the Bay to adopt our local beach and have sponsored many school wide clean-up days. We have recently partnered with the Ballona Institute and are working with their organization to support the Grand Canal Lagoon Restoration Project. Westside Boost aims to bring unique enriching opportunities to the students of Westside Leadership Magnet School and connect these students to the surrounding community.</p> <p>Westside Boost was recently awarded a Community Beautification Grant, totaling almost \$10k, to expand the Westside Leadership Garden located on Buccaneer. With the enthusiastic support of the Los Angeles Unified School District and the City of Los Angeles, Board of Public Works, Office of Community Beautification Grant Program the ground breaking for that project will begin on March, 19th, 2010 and be completed no later than August 25th, 2010.</p>

TOTAL MEMBERS	The proposal must include the names and SIGNATURES of 5 members of the organization (preferably Board members)	YEAR ESTABLISHED
25		2009

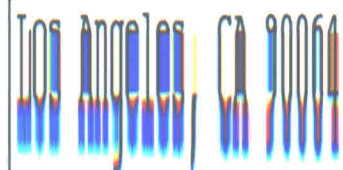
BY SIGNING BELOW, I declare in good faith that I am a member of the organization named above. I realize the Venice Neighborhood Council may contact me to verify my membership and participation in this organization.

NAME	ADDRESS	PHONE	SIGNATURE
Laura Alice	310 Venice Way, Suite B Venice, CA 90291	(310) 482-0422	
Pauline Lyders	422 South Venice Blvd. #1 Venice, CA 90291	(310) 869-3999	
J David Harden	7225 Crescent Park West Los Angeles, CA 90094	(323) 497-6777	
Albert Lee	2746 Stoner Ave. 	(310) 463-6844	
Jeff Kloss	1424 4th Street, #501	(310) 622-3521	



PERMISSION FOR USE OF PROPERTY SHEET (If applicable)

Use this form to show the approval of the use of the project site from the property owner, school principal, city agency, etc. Attach as many as necessary.

PROJECT NAME	Pacific Leadership Garden
APPLICANT	Westside Boost

ENTITY OR NAME OF PERSON WHO CONTROLS USE OF THE PROPERTY	Mr. Cyril Baird	TITLE	Principal
FACILITY/BUSINESS NAME	Westside Leadership Magnet	PHONE	(310) 821-2039
SITE ADDRESS	104 Anchorage Street, Marina Del Rey, CA 90292		

DESCRIPTION OF USE AND PERMISSION NEEDED FOR THIS SITE

I hereby grant permission to Westside Boost to alter the existing garden façade of the Westside Leadership Magnet School site as described in this grant application. I fully support the plan for The Pacific Leadership Garden and look forward to opening new channels of communication between Westside Leadership and our surrounding community.

BY SIGNING BELOW, I declare in good faith that I own or am responsible for the named property. I understand that the applicant is seeking funding through the Venice Neighborhood Council. I grant the applicant permission to use the property for the implementation of the above named project. I understand that the project will begin after July 1, 2010.

2/17/10



VENICE NEIGHBORHOOD COUNCIL
COMMUNITY IMPROVEMENT PROJECT APPLICATION PACKET 2010



COMMUNITY INVOLVEMENT SHEET

PAGE 9

to establish the involvement of Venice stakeholders in this project. This sheet may also be used to document pledges of volunteer hours.

NAME Pacific Leadership Garden

APPLICANT Westside Boost

NAME	ADDRESS	SIGNATURE	DATE SIGNED	NATURE OF INVOLVEMENT	HOURS PLEDGED
Wall	1107 Main St. Venice, CA 90291	<i>A. Wall</i>	2/2/10	Volunteer	10
Amirez	121 E. 109 th Pl. LA, CA 90261	<i>V. Ramirez</i>	2/2/10	Volunteer	10
Amirez	121 E 109 th Pl CA. 90261 <small>Los Angeles</small>	<i>V. Ramirez</i>	2/2/10	Volunteer	10
Fleaharty	2828 Hope St Walnut Park CA	<i>J. Fleaharty</i>	2/2/10	Volunteer	15
in Castro	5743 2nd Ave	<i>Clayton Castro</i>		Volunteer	10
Lyders	4225 Venice Blvd #1	<i>Lyders</i>	2/23/10	Volunteer	15
SANTIAO	3759 1/2 S. BENTLEY AVE	<i>S. Santiago</i>	2/23/10	Volunteer	10
Demay	12 24 th Ave #8 Venice	<i>Demay</i>	2/25/10	Supporter	
Williams	1524 Venice Blvd.	<i>Williams</i>	2-25-10	Supporter	
elmer	21 Top Sail St #1	<i>elmer</i>	2/25/10	Supporter	
Baird	22819 Madison St, Torrance	<i>Baird</i>	2/25/10	Volunteer	10
ll Simpson	104 Anchorage St. Marina Del Rey	<i>Simpson</i>	2/25	Supporter	
Aleman	10302 7 th Ave. LA CA 90043	<i>Aleman</i>	2/25	Supporter	
n Geier	1135 S. Holt Ave LA, CA 90035	<i>Geier</i>	2/25	Volunteer	10

Letters of support from the community behind this page. Letters that state something unique about the project or people who will be directly affected by the project will have a greater impact.



COMMUNITY INVOLVEMENT SHEET

to establish the involvement of Venice stakeholders in this project. This sheet may also be used to document pledges of volunteer hours.

NAME: Pacific Leadership Garden APPLICANT: Westside Boost

NAME	ADDRESS	SIGNATURE	DATE SIGNED	NATURE OF INVOLVEMENT	HOURS PLEDGED
RAYON	11835 SW 17th Ave, Lx CA 90046	[Signature]	2/3/10	Volunteer	10
TELSOBE	4429 INGLEWOOD BLVD, MAR 15TH	[Signature]	2/1/10	Volunteer	10
KARASK	1516 Wellesley Ave 90025	[Signature]	2/2/10	Volunteer	10
WILD	104 E ANCHORAGE	[Signature]	2/2/10	Volunteer	10
Sager-Ebling	32183 Ave #1	[Signature]	2/2/10	Volunteer	10
ROSS	5226 BRENDA AVE	[Signature]	2/2/10	Volunteer	10
Scaturro	312 Venice Way 90291	[Signature]	2/1/10	Volunteer	15
turro	310 Venice Way 90291	[Signature]	2/18/10	Volunteer	10
eadous	1839 W 6th St	[Signature]	2/2/10	Volunteer	10
eadous	1839 W 6th St	[Signature]	2/2/10	Volunteer	10
bedg	6529 1/2 BRY Hurst Tn. LA 90221	[Signature]	2/23/10	Volunteer	10
ayriga	535 Santa Clara Ave #18, Venice CA 90291	[Signature]	2/29/10	Volunteer	10
NOS	535 SANTA CLARA AVE #18 90291	[Signature]	2/23/10	Volunteer	10
KARASK	1516 Wellesley CA 90025	[Signature]	2/26/10	Volunteer	10

Letters of support from the community behind this page. Letters that state something unique about the project or who will be directly affected by the project will have a greater impact.

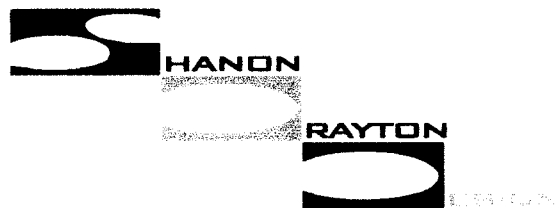

February 23rd, 2010

RE: Westside Boost's Pacific Leadership Garden

To Whom It May Concern:

I have been a property owner in the neighborhood of Westside Leadership Magnet school since 1999. I live on Buccaneer Street directly adjacent to the school's yard. For years I have told people that I live next to a school. Everyone always asks the same thing, "what school?" Our little neighborhood school has gone unnoticed and without improvements for too long. I would like to personally nominate Westside Boost's Pacific Leadership Garden for the Venice Neighborhood Council Community Improvement Project.

During the course of the last year, I have had the opportunity to meet several parents and staff members from the school. They are dedicated to making the campus more beautiful for the students as well as the community. Already I have enjoyed the improvements taking place on the campus in the garden directly across from my property. I am grateful. Almost everybody in our neighborhood passes the front of the school on their way to get their daily morning coffee. We would be grateful to the VNC for any help they can give this small school to improve the campus for the benefit of the entire community.

If you have any questions, or require further information, please don't hesitate to contact me.

Thank you for your kind consideration.

Shanon Drayton

Regan Kibbee

9.3

1716 Washington Way • Venice, CA 90291
E-Mail: regan@qofv.com • Web: <http://groups.yahoo.com/group/venicemoms>

February 24, 2010

Venice Neighborhood Council
Community Improvement Projects

To Whom It May Concern:

This letter is to voice my strong support of a VNC Community Improvement Project grant for the "Pacific Leadership Garden" at Westside Leadership Magnet School.

My name is Regan Kibbee. I am a native Angeleno and 30 year resident of Venice, CA. I currently live with my husband and our 5-yr-old daughter in a house just off Venice Blvd by the Library. Like many Venice residents, until recently I was completely unaware of Westside Leadership Magnet, a public school a mere 5 minute drive or 15 minute walk from our house. Perhaps this unfamiliarity was partially due to a lack of local involvement in the school.

Unlike most of our Venice area elementary schools, the majority of Westside Leadership Magnet's students are bused or driven here from other parts of the city. Due to financial and/or time constraints, most of their parents are unfortunately unable to be as involved in the school as they might like. Therefore, the task of improving the school (and fund raising) generally falls upon a quite small but enthusiastic group of dedicated parents.

Although our daughter is currently in kindergarten at a Montessori school in Culver City, my husband and I are keeping an eye on Westside Leadership Magnet for the future. While we are attracted by the school's focus on leadership skills, their K-8 span and modest population, the facilities and grounds are rather dismal and off-putting. How sad that kids travel across the city to this spare campus that could so much better reflect its prime location just a block from the sea!

I encourage you to award Westside Boost the funds sought to re-landscape the school facade on Pacific Avenue. I believe this would be a great step in improving the school and it's appeal for the surrounding community.

Respectfully yours,

Regan Kibbee

February 24, 2010

Venice Neighborhood Council
PO Box 550
Venice, CA 90294

To Whom It May Concern:

My husband and I have lived in Venice just a short walk from Westside Leadership Magnet School for over 6 years. I have three children and have recently opened my Chiropractic practice here in Venice. I recently began the search for a local Kindergarten for my daughter and discovered, much to my surprise, that there is a fabulous local magnet school called Westside Leadership Magnet.

I am so impressed with the energy, dedication and commitment of the administrators, teachers, staff and parents. The academic and esthetic changes they have made to the campus over the last year are amazing! They are working hard to turn an ugly duckling into a swan so that the entire community can be proud. I feel that their hard work should be applauded and supported. I would like to nominate Westside Boost's Pacific Leadership Garden for the Venice Neighborhood Council Community Improvement Project. Westside Boost is a fantastic organization committed to integrating the school seamlessly and beautifully into the community. If you have any questions or comments please don't hesitate to give me a call at: 310-455-6088. Thank you for your time and consideration of this matter.

Sincerely,

Danielle D. Sager, D.C.

Danielle D. Sager, D.C.

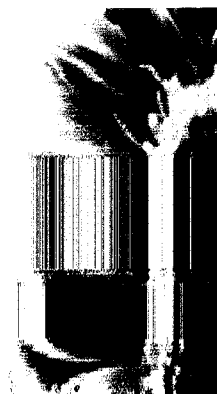



the Voice for Nature on the Los Angeles coast

Ballona Institute is a biodiversity project of the International Humanities Center

March 1, 2010

Venice Neighborhood Council
Community Improvement Projects
PO Box
Venice, CA

Dear Neighborhood Council leadership:

Our organization is fully in support of Westside Boost and their efforts to green and improve the Westside Leadership Magnet School, specifically the Pacific Avenue native plant landscaping project, which will not only beautify the area, but also add native plant pollination possibilities for the nearby ESHAs (Environmentally Sensitive Habitat Areas) of Grand Canal Lagoon, Ballona Lagoon and Venice Canals.

We have forged an important partnership with this school and Westside Boost this past year, and we believe our collaboration is not only leading to an improved beautification effort in the area, but also a significantly enhanced environmentally-themed education for the students who attend Westside Leadership Magnet School.

These students are the future of Los Angeles, and your support of this work will benefit our community for many decades to come.

Should you have questions, please feel free to contact us.

With kindest regards,

Marcia Hanscom

Marcia Hanscom
Co-Director



322 Culver Blvd., #317 ~ Playa del Rey, CA 90293
(310) 823-7040 ~ Shallow Water Nature Store: (310) 578-5888 ~ (310) 448-1219 (fax)