



FINAL CONCEPT PLAN

LINCOLN TO WASHINGTON





KEY

-  ENRICHED PAVING
-  BIKE LANE
-  SCORED CONCRETE DIAMOND PATTERN

LIGHTING (DUAL SYSTEM)

-  SINGLE / DOUBLE CITY STD. LOW CUT-OFF COBRAHEAD CONC POLE, 400W. HPS LAMP 140' SPACING 35' HEIGHT MODEL: C.D. 514E
-  ORNAMENTAL LUMINAIRE ACORN HEAD CONC POLE 50W. METAL-HALIDE LAMP 70' SPACING 14' HEIGHT MODEL: C.D. 503

PLANT MATERIAL

-  MEXICAN FAN PALM (WASHINGTONIA ROBUSTA) TO 80' HEIGHT TALL, THIN TRUNKS, TRIPLE STAND, D.S. TREE WALLS
-  CORAL TREE MEDIAN TREE
-  SHADE / SCREENING TREE
-  GRASS / GROUNDCOVER

CALIFORNIA STATE COASTAL CONSERVANCY

VENICE BLVD WORKSHOP

SCALE 1" = 40' 80' 120' FEB 27, 1989

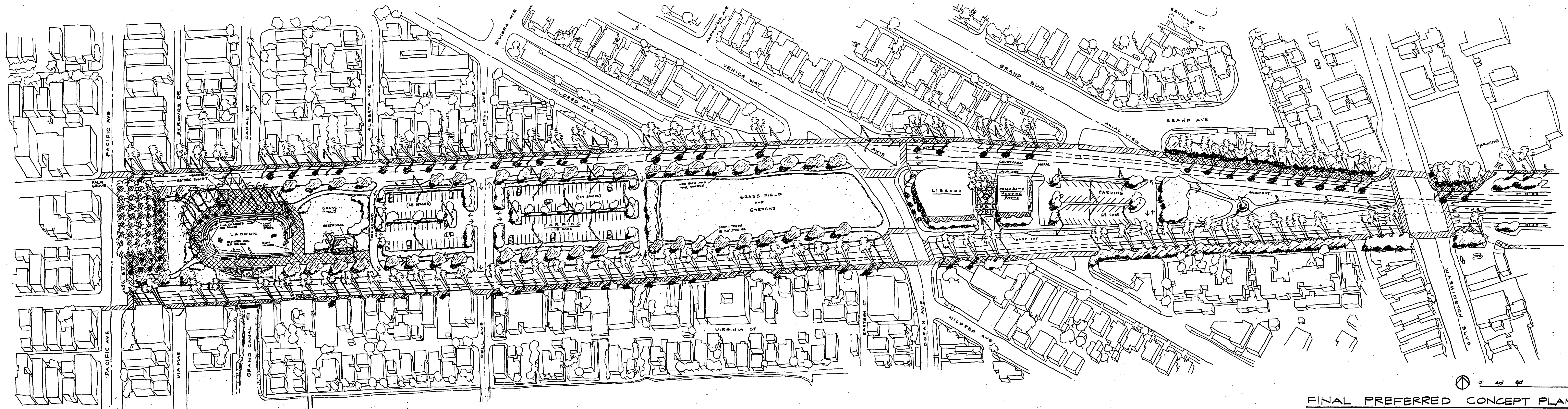

"VENICE BOULEVARD PARK"

FINAL PREFERRED CONCEPT PLAN
 VENICE BOULEVARD WORKSHOP
 CALIFORNIA STATE COASTAL CONSERVANCY

