



**APPLICATION SUMMARY SHEET**

**RECEIVED** PAGE 1

MAR 02 2011

PROJECT NAME  
Beethoven's Learning Garden

BRIEF PROJECT DESCRIPTION (50 WORDS OR LESS)  
Our proposal is to create and run a functioning Learning garden at Beethoven elementary school. This environment is where students will discover, learn and play though cultivating and harvesting healthy fruits, vegetables and herbs. The Garden will be low-cost and low-maintenance, designed for enrichment of the students, teachers and the community families in mind.

PROJECT SITE NAME AND FULL ADDRESS:  
Beethoven Elementary School, 3711 Beethoven St. Los Angeles CA 90066

PROJECT COMPLETION DATE  
September 30<sup>th</sup>, 2011

# OF VENICE STAKEHOLDERS TO BENEFIT BY THIS PROJECT: 375+ Our student body and booster club is comprised of many Venice residents. Beethoven is also a feeder school to Venice High school.

ORGANIZATION OR STAKEHOLDER NAME  
FOB: Friends of Beethoven Booster Club

QUALIFYING ADDRESS FOB: Friends of Beethoven, 3711 Beethoven Ave Los Angeles CA 90066  
Natacha Roy: 2406 Penmar Ave Venice CA (Parent Volunteer & FOB member)

DAY PHONE 310-398-6286	EVENING PHONE	CELL PHONE
E-MAIL ADDRESS <a href="http://www.friendsofbeethoven.org">www.friendsofbeethoven.org</a>		FAX

PROJECT MANAGER Wen-Chia Parker	TITLE Secretary & Green Chair
---------------------------------	-------------------------------

MAILING ADDRESS 3745 Maplewood Ave Los Angeles CA 90066

DAY PHONE 310-254-6858	EVENING PHONE 310-313-0183	CELL PHONE 310-254-6858
E-MAIL ADDRESS <a href="mailto:wenchia@gmail.com">wenchia@gmail.com</a>		FAX

BY SIGNING BELOW, I agree to the terms of the 2011-12 Community Improvement Project funding guidelines. I also acknowledge that the information submitted in this application is accurate to the best of my knowledge. Submitting an application with misleading information may be cause for disqualification.

AMOUNT REQUESTED  
\$2,000.00

Natacha Roy  
STAKEHOLDER SIGNATURE

2/18/2011  
DATE

REVIEW (For Office Use Only)

Wen-Chia Parker  
PROJECT MANAGER SIGNATURE

02/18/2011  
DATE

PROJECT # (For Office Use Only)  
H



**PROJECT DESCRIPTION SHEET**

**PROJECT DESCRIPTION** (Include how many stakeholders will be working on this project.) (Maximum 500 words)

Our proposal is to create and run a functioning Learning garden at Beethoven elementary school. The goal is to create an environment where students will discover, learn and play in a garden that is low-cost and low-maintenance designed for students, teachers and the community families in mind.

Beethoven's Learning Garden would provide spaces to do the following:

1. Grow and harvest healthy fruits, vegetables and herbs for the school.
2. Outdoor space for the teachers and special programs to teach groups on science and health lessons in an open environment.
3. Specialized learning zones, where the students are encouraged to play and self explore aspects of nature, such as native insect, wildlife and plant species.
4. Open creative space allowing students to create their own projects out of naturally found materials and role-play such as archeologist, botanist, farmers, landscape designers.
5. Student participatory composting program that will continuously supply the garden with rich organic soil amendment as well as teach the students about the food-cycle and the importance of reducing, recycling re-using our natural resources.

Beethoven's Learning Garden will accommodate a variety of opportunities and activities. The area has locations for small group discussions such as a teacher meeting with parents. It's also designed to comfortably handle classes up to 26 students who might be there to learn about what's growing in their garden, to understand the science that comes from using the compost facilities to sustain and enhance the garden's fruit trees, vegetables and native plants or simply to hear a story read by a teacher and other students.

Part of the garden will house a native butterfly and insect sanctuary as part of its science curriculum. They will be incorporated with the planting of native Californian plants and flower species.

Beethoven's Learning Garden is designed as a balanced platform for multi-purpose use. The benches serve as a seating area but also as worktables and storage for the tools necessary to tend the garden. The garden is designed to have multiple activities available for students and teachers to engage. Venice community members such as Master Gardeners and Venice High School Staff and students of the Venice High School Learning garden will be an integral part of building and maintaining the garden. Learning, exploring and playing are all activities that students, teachers, parents and visitors can do in the garden. All will be inspired, when using this multifaceted Beethoven learning garden, a unique realm designed for the greater community in mind.

IS THIS PROJECT PART OF A LARGER PROJECT?  YES

**COMMUNITY BENEFIT** (Description of benefit to the entire community and justification for these benefits)

Beethoven's Learning Garden echoes the Venice community's green and sustainable living priority. Beethoven serves over 375 local area students and their families, whom many reside in the Venice community. Our school has been a leader in tree planting, natural landscaping, beautification, composting and now a learning garden. The Venice community will be welcomed to visit our neighborhood garden to see the hands-on learning our students are experiencing. A long-term goal is sharing our harvest and knowledge at a 'community school garden' booth at the Venice farmers market. Beethoven Elementary is a feeder school to Venice High School, which has a thriving Learning Garden. It is our goal for our student's education in gardening, health and environmental awareness to begin at an early age and continue and prosper through their years of education. Through this grant, Beethoven intends to provide a road map to other community schools of our achievements and to engage them in a learning garden for the health and growth of all in our community.



**BUDGET SHEET**

Applicants previously receiving Community Improvement Funds must complete Parts A & B (see instructions)  
Applicants previously unfunded should only complete Part A – No match is required

PART A - VENDOR AND MATERIALS/SERVICES INFORMATION	TOTAL COST	NOTES
<u>Standard Expanded Metal Picnic Tables</u>		Home Depot
Standard Expanded Metal Picnic Tables 476.54 x 2	953.08	www.outdoorschoolfurniture.com
Step2 Outdoor Storage Bench 5433KR 99.99 x 6	599.94	Home Depot.com
Plastics Bench will be used as garden work tables 59.97 x2	119.94	Home Depot.com
Rubbermaid Large lockable Vertical Storage Shed	299.99	Home Depot
<p>Please note the above costs of materials are from Home Depot retail store, HomeDepot.com and Amazon.com. The materials listed are what are necessary to support the outdoor classroom Science Center and Natural Wonder Exploration. These are the basic supplies necessary for the Student and Staff to utilize the garden starting in September of 2011 as part of the school life science and enrichment study.</p> <p>The FOB, Friends of Beethoven will continue to build upon this Learning garden and will be adding more features and detail as we come to more funding. All of the labor in building the project will be donated by the members of Friends of Beethoven. Please see page 4 for additional details.</p>		
<p align="right"><b>PROJECT TOTAL (PARTS A &amp; B)</b></p>	<p align="right"><b>\$ 1972.95</b></p>	



**PROJECT PLANNING SHEET**

**WORK PLAN** (Include a TIME-LINE for the project with beginning date and completion date of each phase)

**Funding from other programs:**

- Soil – donated by LA City’s free soil program
- Fruit Trees – donated by LACC with support from Tree People
- Evergreen Trees – donated by LACC with support from Tree People
- Plants and seeds – donated by Venice HS Learning Garden
- Labor: Excavation, preparation and development of site – Volunteer labor.

This preparation of this project has already begun as of Feb 01, 2011  
 February-March 2011, Early Mornings on School days, Parent & community volunteers are clearing the site area and preparing for garden beds.  
 Preparation work includes site layout and planning, moving plants, moving mulch, clean up of site, layout of cardboard for garden rows, hauling and laying of compost in each row, starting of seedlings and plants to be planted.  
 April 2011, Beethoven School Beautification day, our seasonal school clean-up work day, the main focus of Beautification day is clean up the school campus and utilize our large work force to trim, trees, bushes, and move soil and compost.  
 July- August 2011, with Funds from VNC build Garden beds, Natural Wonders Exploration area, Set Stone pavers, benches and storage bin.  
 Parent volunteers of FOB will have scheduled workdays to complete the garden to ready for Teacher and Staff use when school starts in September 2011.

**MAINTENANCE PLAN** (If applicable)

The students, staff and community volunteer members will utilize the Learning Garden year round during the school year at Beethoven Elementary School. The funding for the tools, storage and benches will be critical for the proper use and maintenance of the garden.  
 The Beethoven Learning garden will work in conjunction with the USC Master Gardener’s program, so Master Gardeners will be on site year round to help in the education of students, and maintenance of the garden site.  
 The Learning garden will also work with Growing Great curriculum, which has been in place at Beethoven as a seasonal partnership of garden and nutrition lessons that are designated portion of the LAUSD Life Science curriculum.

Proposed Beethoven Learning Garden Site Location

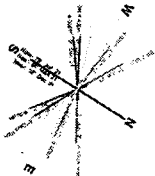

PROJECT TITLE:  
**BEETHOVEN  
ELEMENTARY  
SCHOOL -**

3711 BEETHOVEN ST.  
LOS ANGELES,  
CALIFORNIA 90086

SHEET TITLE:  
**SITE PLAN**

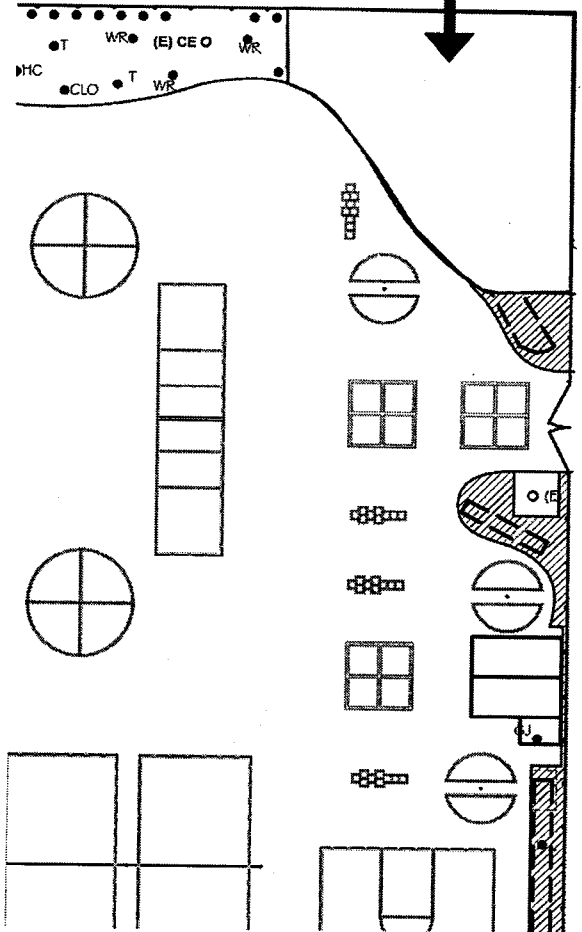

Greenwood Avenue

Victoria Avenue

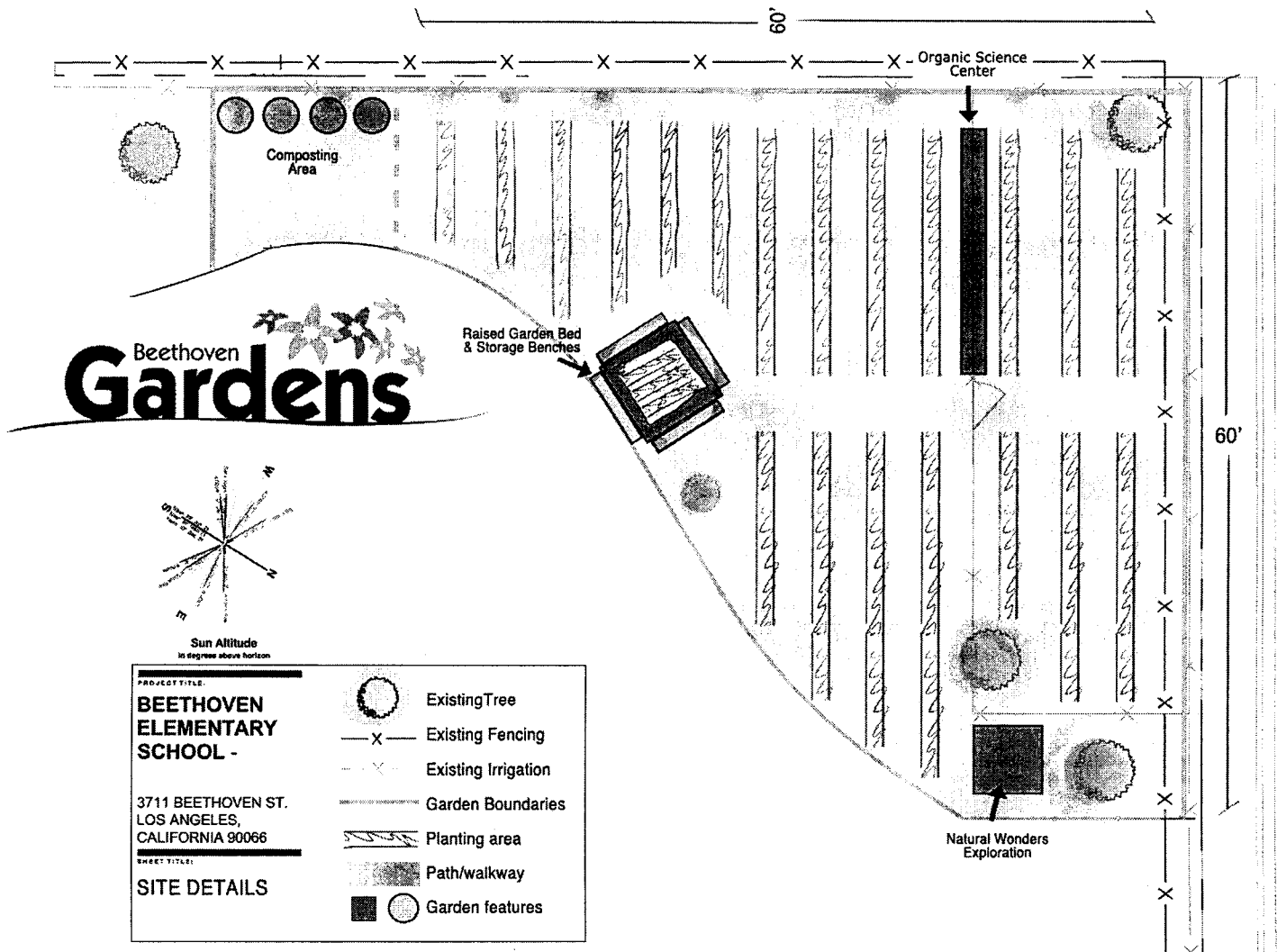

VENICE NEIGHBORHOOD COUNCIL  
COMMUNITY IMPROVEMENT PROJECT APPLICATION PACKET 2011

**ORGANIZATION SHEET (If applicable)**

PAGE 6

(Only complete this form if the applicant is an organization. If so, do not complete Page 7)

ORGANIZATION NAME FOB: Friends of Beethoven 501c3 EIN# 95-4415920

ORGANIZATION ADDRESS: 3711 Beethoven Street, Los Angeles CA 90066

**ORGANIZATION DESCRIPTION AND PURPOSE (Include the experience that your organization has in the execution of similar projects)**

Established in 1993, The Friends of Beethoven Booster Club, FOB is an organization of parent volunteers whose purpose is to raise money to enhance the students' learning environment at Beethoven Street Elementary School. The Booster Club is also responsible for the ongoing cultivation of community partnerships with local businesses, community-based organizations, and government organizations that will contribute to and support Beethoven Street Elementary School.

FOB is comprised of diversely talented parents and professionals who have strong project management and administration skills, as well as gardening and painting abilities. Over the years, the Booster Club has been responsible for and successfully managed multiple beautification projects on the Beethoven St. Elementary School campus. In 2006, the Booster Club has successfully created from start to finish *The Learning Terrace*, an outdoor space for students to read and work in small groups, funded by the Office of Community Beautification.

In 2005, the Booster Club began transforming the kindergarten yard into *Beethoven Park*, planting trees and gardens, painting the equipment and buildings, and raising funds for new playground equipment and fencing. **Our new Learning garden** is an opportunity to provide a space for our students to explore as well as grow beautiful and healthy fruits and vegetables. The goal is to nourish their minds as well as their bodies.

TOTAL MEMBERS  
375+

**The proposal must include the names and  
SIGNATURES of 5 members of the organization  
(preferably Board members)**

YEAR ESTABLISHED  
1993

BY SIGNING BELOW, I declare in good faith that I am a member of the organization named above. I realize the Venice Neighborhood Council may contact me to verify my membership and participation in this organization.

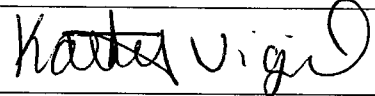
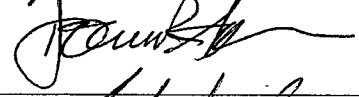
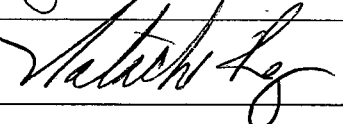
NAME	ADDRESS	PHONE	SIGNATURE
Wen-Chia Parker Secretary of PTA & FOB	3745 Maplewood Ave	310-254-6858	
Kathy Vigil Vice President of FOB	2106 Walnut Ave	(310) 702-1012	
Mark & Andrea Andrews Co-Presidents of FOB	12625 Woodgreen St	(310) 863-3061	
<del>John Ayers &amp;</del> Donna Ayers Treasure of FOB	12713 Marco Place	310-779-7182	
Natacha Ray FOB Member	2406 Penmar Ave	310 574-4989	

VENICE NEIGHBORHOOD COUNCIL  
COMMUNITY IMPROVEMENT PROJECT APPLICATION PACKET 2011

**PERMISSION FOR USE OF PROPERTY SHEET (If applicable)**

PAGE 8

Use this form to show the approval of the use of the project site from the property owner, school principal, city agency, etc.  
Attach as many as necessary.

PROJECT NAME Beethoven's Learning Garden

APPLICANT FOB: The Friends of Beethoven Booster Club

ENTITY OR NAME OF PERSON

TITLE Principal

WHO CONTROLS USE OF THE PROPERTY Dr. Althea Ford

FACILITY/BUSINESS NAME Beethoven Elementary School

PHONE 310-398-6286

SITE ADDRESS 3711 Beethoven Street Los Angeles CA 90066

DESCRIPTION OF USE AND PERMISSION NEEDED FOR THIS SITE

To create and run a functioning Learning Garden on the North West corner of the Beethoven Elementary School campus. The lot is approximately 60 feet by 60'; Please refer to attached site map. The Learning Garden will be utilized and operated by students, school staff, and school approved community volunteers during school hours and designated afterhours. The site will be cultivated to grow fruits, vegetables, herbs, native Californian flowers and plants to be utilized in teaching science and nutrition to the students of Beethoven Elementary School.

BY SIGNING BELOW, I declare in good faith that I own or am responsible for the named property. I understand that the applicant is seeking funding through the Venice Neighborhood Council. I grant the applicant permission to use the property for the implementation of the above named project. I understand that the project will begin after July 1, 2011.

  
SIGNATURE

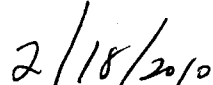
  
DATE





**COMMUNITY INVOLVEMENT SHEET (must be completed by all applicants)**

Use this sheet to establish the involvement of Venice stakeholders in this project. This sheet may also be used to document pledges of volunteer hours.

PROJECT NAME Beethoven Learning Garden

APPLICANT Friends of Beethoven

NAME	ADDRESS	SIGNATURE	DATE SIGNED	NATURE OF INVOLVEMENT	HOURS PLEDGED
Wen-Chia Parker	3745 Maplewood Ave	<i>[Signature]</i>	2/18/11	Project manager Master Gardener TB	unlimited 100+
Erik Salzman	3720 Boise Ave	<i>[Signature]</i>	2/18/11	Volunteer	50
Chaira Nguyen	3744 Meier st	Elvira Nguyen	2/18/11	Parent Volunteer	8
Charlene Decker	2312 SUPERIOR AVE	<i>[Signature]</i>	2/18/11	Parent Volunteer	100+
Madell Spence Sailer	4055 Wade St #6	<i>[Signature]</i>	2/18	Parent Volunteer	100+
Marye Motimer	3764 Maplewood Ave	<i>[Signature]</i>	2/18	Parent Volunteer	100+
Patt Segura	12226 Admiral Ave	<i>[Signature]</i>	2/18	Parent Volunteer	100+
Aaron McSturay	3245 Rosewood Ave	<i>[Signature]</i>	2/18	Parent	100+
Veronica Evans	3775 Beethoven St. 161	<i>[Signature]</i>	2/18	Parent Volunteer	50+
Shari Bossel	3765 Greenwood Ave 4th grade	<i>[Signature]</i>	2/18	Parent Volunteer	100+
Barbara	12420 32nd Ave	<i>[Signature]</i>	2/18	Parent Volunteer	100+
Brooke Ramirez	1883 3711 Beethoven St	<i>[Signature]</i>	2/18	Teacher	100+
Danna Joki	3761 Boise Ave grade	<i>[Signature]</i>	2/18	Parent	100+
Patricia Arguando	3711 Beethoven St. grade	<i>[Signature]</i>	2/18	Teacher	100+

Attach letters of support from the community behind this page. Letters that state something unique about the project or from people who will be directly affected by the project will have a greater impact.



**COMMUNITY INVOLVEMENT SHEET (must be completed by all applicants)**

Use this sheet to establish the involvement of Venice stakeholders in this project. This sheet may also be used to document pledges of volunteer hours.

PROJECT NAME Beethoven Learning Garden APPLICANT FOB: Friends of Beethoven

NAME	ADDRESS	SIGNATURE	DATE SIGNED	NATURE OF INVOLVEMENT	HOURS PLEDGED
Ryan O'Donnell	7925 Hollywood Blvd Apt 416	<i>Ryan O'Donnell</i>	2/18/11	Teacher	
Corby Arthur	<sup>Beethoven</sup> 3711 Beethoven St. LA 90066	<i>Corby Arthur</i>	2/18/11	Teacher	100
Amalyn Mill	3711 Beethoven St 90066	<i>Amalyn Mill</i>	2/18/11	Teacher	100
Marianne Tanker	3794 <del>Beethoven</del> <sup>Beethoven</sup> St, 90066	<i>Marianne Tanker</i>	2/29/11	Grandparent	50
Belkis Cosca	12741 Venice Blvd LA 90066	<i>Belkis Cosca</i>	2/29/11	parent	50
Haydee Valeriano	12915 Venice Blvd #20, LA, 90066	<i>Haydee Valeriano</i>	2/22/11	Parent	50
Jessie Quispe	19766 Pacific Ave <sup>90066</sup> LA 90066	<i>Jessie Quispe</i>	2/22/11	Parent	50
Isabel Lenn	3655 Mary St. LA CA	<i>Isabel Lenn</i>	2/22/11	parent	50
Jeanne Avens	12713 WAREO	<i>Jeanne Avens</i>	3/10/7797182		
Eric Barnett	163rd Ave Apt A3	<i>Eric Barnett</i>	310-463-2489		
Utacka Roy	2100 Fenner Ave Venice	<i>Utacka Roy</i>	310-574-4989		
Paula Siller	1517 1/2 Venice 131	<i>Paula Siller</i>	310 398-8756		

Attach letters of support from the community behind this page. Letters that state something unique about the project or from people who will be directly affected by the project will have a greater impact.

Christine Spines  
2445 Walgrove Avenue  
L.A., CA 90066  
(310) 429-3586  
[cspines@gmail.com](mailto:cspines@gmail.com)

February 21, 2011

Re: Beethoven Learning Garden

Dear Venice Neighborhood Council:

I am writing to voice my wholehearted support for the proposed Learning Garden at Beethoven Elementary. As a longtime Venice resident and a parent with a child currently attending Beethoven, I know first-hand how much this garden would enhance and benefit the community within the school and beyond. Cultivating natural open space on the school yard would not only provide an empirical lab to enhance school's ecology and natural science curriculum, it would also beautify the campus, which is currently dominated by an asphalt black top. By providing a park-like resource for the school and surrounding area, the neighborhood more attractive and raises property values.

I live directly across the street from the Venice Learning Garden, which has raised my quality of life exponentially. It has provided a sanctuary, where my family regularly explores nature in its native and unmanicured state. It has also been a place where I've learned how to grow some of my own food and my son has taken classes, which have helped him understand his relationship and responsibility to the natural world. This kind of resource would be invaluable to Beethoven and the community at large. By providing a low-cost, high-impact improvement to the learning environment, the Beethoven Learning Garden would create an enduring improvement to the school and a corrective to dwindling school budgets.

I hope you'll see as much value to our community in this proposal as my family does. Please don't hesitate to contact me with any further questions. Thank you in advance for your consideration.

Kindest regards,  
Christine Spines



Date 2/24/11

Venice Neighborhood Council  
PO Box 550  
Venice, CA 90294

To Whom It May Concern,

The Girl Scouts of Greater Los Angeles Troop #925 is pleased to provide support to the Beethoven Learning Garden. Since most of our troop members either are or were students at Beethoven Street Elementary School, this will provide a great community service opportunity right at our doorstep.

Our troop, which consists of over 70 students from Kindergarten through High School, is learning the importance of taking care of their school campus and community as well. Our Brownies (2nd-3rd Grade) have already started seedlings of the California Native Milkweed Flower in preparation for it's addition into the Learning Garden this summer to attract Native Butterflies.

The Beethoven Learning Garden is a wonderful place for our girls to hold their meetings and learning about the environment.

We have committed to providing our Scouts to help with care and maintenance of this garden for the next five years and beyond.

I give this project my highest recommendation and ask that you award this grant to the Friends of Beethoven Booster Club to help beautify and enrich the community of Beethoven Street Elementary.

Sincerely yours,

Gloria Halfacre  
Leader, Girl Scout Troop 925  
Co-Manager, Marina Service Unit

3483 Beethoven Street  
Los Angeles, California 90066  
T 213 740 7445  
C 310 739 7107  
F 213 740 6618  
gloria@sipi.usc.edu

Julie Mann  
2454 Louella Avenue,  
Venice, CA

February 25, 2011

Re: Beethoven Learning Garden

Dear Venice Neighborhood Council:

I am writing to voice my wholehearted support for the proposed Learning Garden at Beethoven Elementary. As a longtime Venice resident, Board Member of the Venice High School Learning Garden, Teacher, Parent and Gardener, I know first-hand how much this garden would enhance and benefit the community within the school and beyond.

Cultivating natural open space on the school yard would not only provide an empirical lab to enhance school's ecology and natural science curriculum, it would also beautify the campus, which is currently dominated by an asphalt black top. By providing a park-like resource for the school and surrounding area, the neighborhood more attractive and raises property values.

This kind of resource would be invaluable to Beethoven and the community at large. By providing a low-cost, high-impact improvement to the learning environment, the Beethoven Learning Garden would create an enduring improvement to the school.

I hope you'll see as much value to our community in this proposal as I do. Please don't hesitate to contact me with any further questions.

The Venice High School Learning Garden will be helping Beethoven every step of the way in building their garden though access to resources in gardening knowledge and supplies of soil, seeds, and plants. Thank you in advance for your consideration.

Kindest regards,  
Julie Mann  
Venice High School Learning Garden  
ma13nn@aol.com