

SIGNAL STANDARD SCHEDULE					
No.	TYPE	FOUND. TYPE	PED. PUSH BUTN TYPE	PHASE	REMARKS
1	332 Cab.	F-332	-	-	ATSAC 2070 Controller in 332 Cabinet
2	CD814E	BSL	6"	3	
3	CD814ET	BSL	6"	3	
4	1	F-1	4"	2	
5	16	F-2	6"	2	
6	CD814E	BSL			
7	CD814ET	BSL			
8	1	F-1	4"	6	
9	16	F-2	6"	6	

* Existing

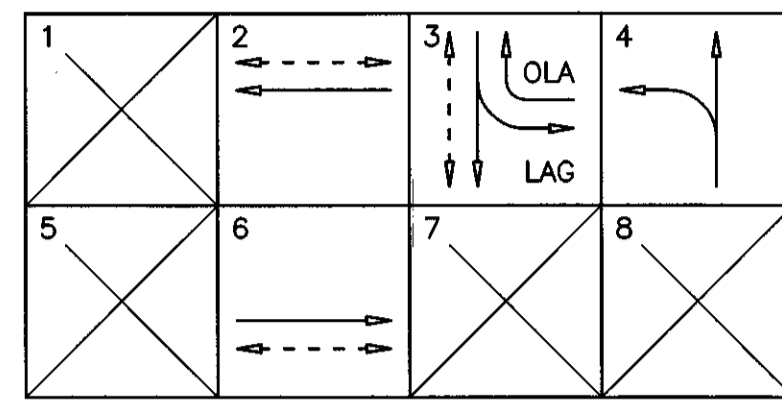

EXISTING PHASE DIAGRAM

NOTES:

- FULLY-ACTUATED OPERATION (ATSAC 2070 CONTROLLER IN 332 CABINET)
 #2 - WASHINGTON BLVD. WB & N/S PED. XING
 #3 - PACIFIC AVE. SB, SB LT & W/S PED. XING
 #4 - PACIFIC AVE. NB & NB LT
 #6 - WASHINGTON BLVD. EB & S/S PED. XING
 OLA - (#3) WASHINGTON BLVD. WB RT
 MAR VISTA ATSAC SYSTEM
 SPREAD SPECTRUM/DIRECT WIRE (CABLE) INTERCONNECT
- INSTALL/REMOVE SIGN(S), STRIPING & PAVEMENT MARKINGS PER LADOT GEOMETRIC DESIGN DWG. NO. A-6402.
- ABANDON AND DISCONNECT DETECTOR LOOP(S) IN PULLBOX AS SHOWN.
- INSTALL DETECTOR LOOP(S) PER LADOT STD. DWG. NO. S-70.1A & S-70.1D CASE II. CONTRACTOR SHALL OBTAIN APPROVAL FROM LADOT INSPECTOR PRIOR TO INSTALLATION OF ANY LOOPS.
- INSTALL BIKE LOOP(S) PER S-70.1D CASE I. CONTRACTOR SHALL OBTAIN APPROVAL FROM LADOT INSPECTOR PRIOR TO INSTALLATION OF ANY LOOPS.
- CONTRACTOR SHALL RE-USE EXISTING STUB-OUT. IF STUB-OUT IS NOT IN PLACE, CONTRACTOR SHALL INSTALL NEW STUB-OUT PER LADOT STD. DWG. NO. S-70.1A.
- CONTRACTOR MAY RE-USE THE EXISTING DLC IN THE PULLBOX AS DETERMINED BY THE TRAFFIC SIGNAL INSPECTOR. SHOULD THE CONTRACTOR DAMAGE THE EXISTING CABLE, NEW DLC CABLE SHALL BE INSTALLED FROM THE PULLBOX TO THE CONTROLLER AT THE CONTRACTOR'S EXPENSE.
- REMOVE SIGN(S), OR SIGN(S) AND POST(S) AS SHOWN.
- CONTRACTOR SHALL CONTACT LADOT SIGNAL DESIGN SECTION AT (213) 928-9640 FOR ANY SIGNAL RELATED PROBLEMS ENCOUNTERED DURING CONSTRUCTION.

CONDUCTOR SCHEDULE		RUN											
SIZE No.	CABLE / WIRE	1	2	3	4	5	6	7	8	9	10	11	12
5	CONDUCTOR CABLE												
5	5 X #14												
9	CONDUCTOR CABLE												
8	8 X #14 & 1 X #12(COM)												
13	CONDUCTOR CABLE												
12	12 X #14 & 1 X #12(COM)												
28	CONDUCTOR CABLE												
27	27 X #14 & 1 X #10(COM)												
6	SERVICE												
8	BONDING (GROUND)												
14	PED PUSHBUTTON												
18	DLC (2 PAIR)	1	1	1	1								
18	DLC (EXISTING)												
18	DLC (3 PAIR)												
14	INTERCONNECT (7 WIRE)												
22	INTERCONNECT (12 PAIR)												
	APS (5x#14)												
CONDUIT SIZE		*	*	*	*	*	*	*	*	*	*	*	*

* FOR EXISTING CONDUIT RUNS DESIGNATED WITH AN "*" (ABOVE), THE CONDUCTOR SHALL ADD/INSTALL NEW CONDUCTORS/CABLES AND PROTECT AND MAINTAIN ALL EXISTING CONDUCTORS/CABLES.

NOTICE TO CONTRACTOR

- EXCEPT WHERE OTHERWISE INDICATED, MATERIALS AND INSTALLATION METHODS SHALL CONFORM TO THE LATEST EDITION, WITH SUPPLEMENTS, OF THE STANDARD SPECIFICATIONS FOR PUBLIC WORKS CONSTRUCTION, ADOPTED BY THE CITY OF LOS ANGELES BOARD OF PUBLIC WORKS (LAPBW), INCLUDING THE LATEST VERSION OF STANDARD PLAN S-610 ISSUED BY THE LAPBW, AND THE LATEST EDITION, WITH AMENDMENTS, OF THE SPECIAL PROVISIONS AND STANDARD DRAWINGS FOR THE INSTALLATION AND MODIFICATION OF TRAFFIC SIGNALS, ISSUED BY THE CITY OF LOS ANGELES DEPARTMENT OF TRANSPORTATION (LADOT).
- ALL TRAFFIC SIGNAL AND/OR RELATED ELECTRICAL WORK SHALL BE PERFORMED AND INSPECTED UNDER THE CONDITIONS OF THE MOST CURRENT AMENDED BOARD OF PUBLIC WORKS "ENHANCED ELECTRICAL SAFETY POLICY" AS REQUIRED IN LADOT'S SPECIAL PROVISIONS AND STANDARD DRAWINGS FOR THE INSTALLATION AND MODIFICATION OF TRAFFIC SIGNALS (RED BOOK), REGARDLESS OF CONTRACT COST.
- THE LADOT TRAFFIC SIGNAL INSPECTOR AT (310) 754-7052 SHALL BE NOTIFIED THREE (3) WORKING DAYS PRIOR TO THE BEGINNING OF CONSTRUCTION. FOR WORK IN THE AUTOMATED TRAFFIC SURVEILLANCE AND CONTROL (ATSAC) PROJECT AREA, A FIELD MEETING SHALL BE SCHEDULED WITH THE SIGNAL SYSTEM SUPERVISOR AT (213) 473-8286 AND THE SIGNAL MAINTENANCE SUPERVISOR AT (310) 754-7044. THREE (3) WORKING DAYS PRIOR TO THE BEGINNING OF CONSTRUCTION, FULL RESTORATION OF THE ATSAC SYSTEM MUST OCCUR WITHIN FIVE (5) WORKING DAYS AFTER SHUT DOWN.
- REGULAR TRAFFIC SIGNAL CONTROL SHALL BE MAINTAINED FROM 6:00 A.M. TO 9:00 A.M. AND 3:00 P.M. TO 7:00 P.M. ON WEEKDAYS, EXCEPT NATIONAL HOLIDAYS. FLASHING, DEACTIVATION AND ACTIVATION OF SIGNALS SHALL BE ACCOMPLISHED ONLY BY A LADOT TRAFFIC SIGNAL ELECTRICIAN. ALL ARRANGEMENTS TO DEACTIVATE SIGNALS SHALL BE MADE 24 HOURS IN ADVANCE BY CONTACTING THE LADOT TRAFFIC SIGNAL DEDICATED LINE AT (213) 473-8478 BEFORE 9:00 A.M. ON NON-HOLIDAY WEEKDAYS. THE LADOT PROJECT NUMBER MUST BE GIVEN AT THIS TIME. THE CONTRACTOR WILL BE CHARGED FOR ALL ELECTRICAL AND TRAFFIC CONTROL SERVICE PROVIDED BY LADOT.
- ARRANGEMENTS FOR OBTAINING ANY MATERIALS IDENTIFIED TO BE SUPPLIED BY LADOT SHALL BE MADE TEN (10) WORKING DAYS IN ADVANCE BY CONTACTING THE LADOT FIELD OPERATIONS DIVISION AT (213) 928-9603. HOWEVER, TRAFFIC SIGNAL CONTROLLERS REQUIRE THIRTY (30) WORKING DAYS ADVANCE NOTICE AND MUST BE PICKED UP WITHIN FIFTEEN (15) WORKING DAYS AFTER NOTIFICATION. CONTACT LADOT SIGNAL SHOP AT (213) 473-8468 TO COORDINATE CONTROLLER DELIVERY AND/OR PICKUP.
- ALL IDENTIFIED TRAFFIC SIGNAL EQUIPMENT SHALL BE RETURNED TO LADOT. ARRANGEMENTS FOR RETURNING IDENTIFIED EQUIPMENT TO LADOT SHALL BE MADE FIVE (5) WORKING DAYS IN ADVANCE BY CONTACTING THE LADOT MATERIAL CONTROL DIVISION AT (213) 928-9636.
- ALL EXISTING TRAFFIC CONTROL SIGNING SHALL BE MAINTAINED WITH STANDARD SIGN BRACKETS BY THE CONTRACTOR. EXCEPT WHERE OTHERWISE INDICATED, EXISTING LARGE STREET NAME SIGNS ON MAST ARM TYPE STANDARDS SHALL BE RELOCATED FROM THE VERTICAL POLE TO THE MAST ARM PER LADOT STANDARD DRAWING NO. S-457.0 AND S-486.0. THE CONTRACTOR SHALL COORDINATE WITH LADOT SIGN SHOP AT (213) 473-7954 FOR ANY REQUIRED LARGE STREET NAME SIGNS. ANY TRAFFIC CONTROL SIGNING DAMAGED OR LOST BY THE CONTRACTOR SHALL BE REPLACED AT THE CONTRACTOR'S EXPENSE. SIGNAL CONTRACTOR SHALL INSTALL MAST ARM MOUNTED SIGNS. FOR THE INSTALLATION OF A STREET NAME SIGN ON A TYPE 1 POLE, THE CONTRACTOR SHALL FURNISH AND INSTALL A POLE EXTENSION AS NEEDED.
- THE CONTRACTOR SHALL FURNISH AND INSTALL, AS SHOWN ON THE PLANS, ALL TRAFFIC SIGNAL EQUIPMENT SUCH AS STANDARDS, MAST ARMS, SIGNAL HEADS, AND OTHER EQUIPMENT AS REQUIRED. ALL SUCH EQUIPMENT SHALL BE NEW. ALL VEHICLE HEAD EQUIPMENT SUPPLIED BY THE CONTRACTOR SHALL HAVE 1-1/2 INCH DIAMETER PIPE FIT MOUNTING HARDWARE, INCLUDING ALL TOP POST MOUNT HEADS, PED HEAD MODULE REPLACEMENTS SHOWN ON THE PLAN SHALL REQUIRE A COMPLETE INSTALLATION, INCLUDING NEW PED HEAD AND TERMINAL COMPARTMENT.

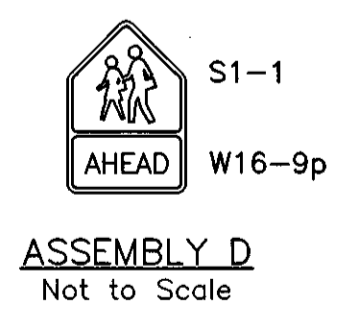
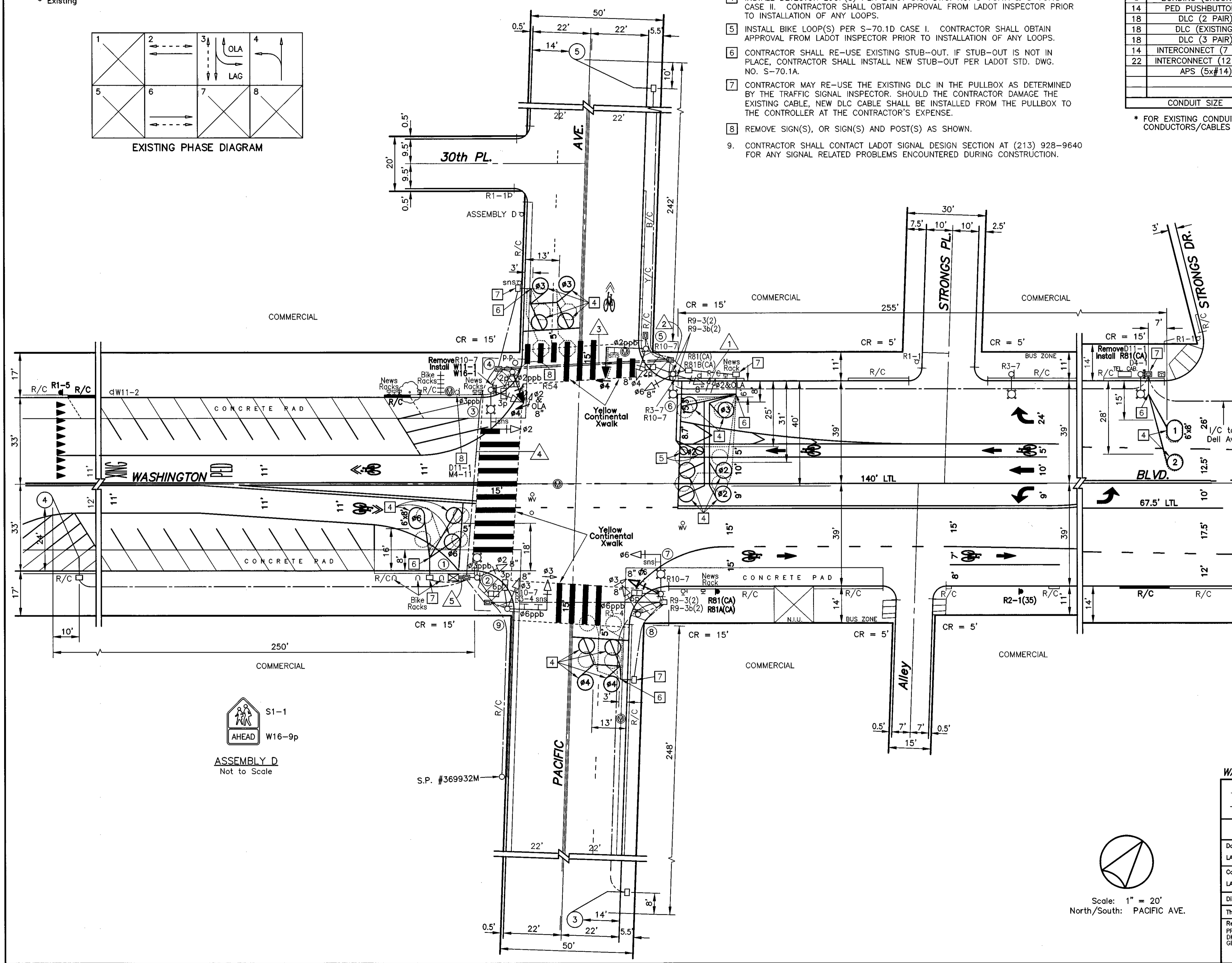

ASSEMBLY D
Not to Scale

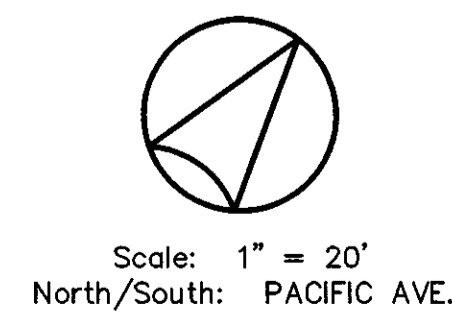

WASHINGTON BLVD. RESURFACING PROJECT

SUBMITTED <u>September 10 20 14</u>	APPROVED <u>Sam Van der</u> 20 14	
<u>Sam Van der</u> Transportation Engineer	<u>M. M. M.</u> Senior Transportation Engineer	
AS BUILT Date of Installation: _____ LADOT Inspector: _____ Condition As Of: _____ LADOT Engineer: _____ District: WESTERN Thomas Guide: 671 H7		CITY OF LOS ANGELES DEPARTMENT OF TRANSPORTATION SELETA J. REYNOLDS, General Manager PACIFIC AVE. & WASHINGTON BLVD.
References PROJECT NO. 74346 "NO AS BUILT" DM103.5A145 DM105A145 GEOMETRIC DESIGN DWG. NO. A-6402	File Name: 20850-21.DWG Intersection No.: 20850 Project No.: PRC11004	NOTICE: IF PLAN HAS NOT BEEN IMPLEMENTED WITHIN TWO (2) YEARS OF THE APPROVAL DATE, IT MUST BE RESUBMITTED TO LADOT SIGNAL DESIGN SECTION FOR REVIEW AND APPROVAL.

(LADOT Revised 09/07)